



ASHE 2021 National Conference

May 25 - 27, 2021

Final Report

ASHE 2021 National Conference
 May 25 - 27, 2021
 Final Report

Introduction

The 2021 ASHE National Conference was unique. Due to the worldwide COVID-19 pandemic, the conference was conducted virtually using the REMO platform.

The 2021 conference was awarded to three sections - the Delaware Valley Section, the East Penn Section, and the North East Penn Section. The original in-person conference was to be held at the Kalahari Resort in the Pocono Mountains of eastern Pennsylvania. The original selected dates were June 9 – 13, 2021. An organization was formed, and committees were organized in accordance with the national conference guidelines.

A request for proposals (for technical presentations) was advertised, guest and technical programs selected, and advertising and sponsorships were solicited.

During November and December, 2020, it became obvious that, although an in-person conference might be feasible, it would not be in keeping with ASHE's tradition of networking and interaction that is so important at a National Conference. The 2021 Conference Committee recommended to National that the conference be virtual and that the three sponsoring sections be awarded the 2025 conference to be held at the Kalahari Resort in the Pocono Mountains of eastern Pennsylvania. National agreed. The dates for the virtual conference were selected to be May 26, 27 & 28, 2021.

Organization

Conference Committees

Assignment	Individual	Section
Co-chair	John Caperilla (MKA)	Delaware Valley
Co-chair	Richard Cochrane (MKA)	NE Penn
Co-chair	Todd Rousenberger (RK&K)	East Penn
Treasurer	Mark Boris* (Borton-Lawson)	NE Penn
Sponsorship Chair	Mark Kinnee (Urban Engr)	Delaware Valley
Technical Chair	Amanda Schumacher* (Borton-Lawson)	East Penn
Exhibit Chair	Frank Summa* (GPI)	NE Penn
Program Chair	Richard Ames* (WSP)	East Penn
Registration & Reception Chair	Christine Frey (TPD)	East Penn
Entertainment Chair	Jeff Obrecht (RK&K)	Delaware Valley
Publicity Chair	James Stanton* (TPD)	Delaware Valley
Golf Chair	Dominic Yannuzzi* (Benesch)	NE Penn
Transportation Chair	Butch Frati (City of Wilkes-Barre)	NE Penn
Guest Program Chair	Jay McGee* (HNTB)	East Penn

*Also served as REMO moderator

ASHE 2021 National Conference
May 25 - 27, 2021
Final Report

Additional volunteers were used as technical session moderators and other tasks. These individuals handled the logistics of the technical presentation, including monitoring the on-line "questions and answers" period.

Name	Role	Section
Ralph Eberhardt (Baker)	REMO Moderator	Delaware Valley
Samantha Safara (HDR)	REMO Moderator	East Penn
James Brady (STV)	REMO Moderator	Delaware Valley
Matthew Dao (TPD)	REMO Moderator	Delaware Valley
Bob O'Neill (Lotus Envir)	REMO Moderator	Delaware Valley
Jerry Fry (AECOM)	REMO Moderator	East Penn
Wayne Howitz (HDR)	Designed conference logo	Delaware Valley

Registration

Registration was done using Constant Contact. Constant Contact is used by the East Penn Section for section scheduling and meeting registration, and the section was gracious enough to share it with the conference. Constant Contact was able to take care of registration, but not sponsors or advertisers.

The conference used Constant Contact in conjunction with PayPal to process payments. It did allow for codes for complimentary registrations, but we chose to manually enter complimentary registrations.

We gave a registration gift to all registrants. The gift, shown in the appendix, was a "PadFolio" with the conference logo embossed on the cover.

For conventional conferences, we suggest using a more robust registration package to manage registrations.

Sponsors

Sponsorships were solicited from a list of about 160 potential sponsors. (See the appendix for the sponsor list.) The list was developed using information from past conferences and the personal knowledge of the conference committee members. Prior to the decision to hold a virtual conference, two sponsors had responded, and were given the option to support the virtual conference at a reduced level, hold the sponsorship for the 2025 conference, or receive a full refund. One sponsor elected to have the sponsorship returned, and one elected to support the conference at a reduced level.

The sponsorship levels (number of sponsors) were:

- Keynote sponsor* (1) - \$1,500
 - Sustaining sponsor (16) - \$1,000
 - Conference sponsor (18) - \$500
 - Table sponsor (4) - \$250
- * The Keynote sponsorship was exclusive

ASHE 2021 National Conference
May 25 - 27, 2021
Final Report

Advertisers

The Conference Committee developed a virtual program book as a digital version of a printed book. It was formatted as an 8½" x 11" book, but was in accordance with the conference guidelines with respect to content. Program books were printed and bound for award winners and for archiving purposes. The program book is in the appendix.

Program book advertisements (number of advertisements) had three categories:

- Page 2 advertisement (Second page of the virtual advertising book) (1) - \$500
- Full-page advertisement (18) - \$250
- Half-page advertisement (7) - \$125

ASHE Business meeting

The annual ASHE business meeting was conducted on May 25 at noon, and the award presentations were made on May 27 at noon. Agenda are in the appendix. The annual Section / Region Officers meeting was held on May 26 at noon, but it was on a separate video conference platform, to allow the officers to attend without registering for the conference.

Overall conference agenda

The overall agenda can be found at the conference website at <http://www.2021conference.ashe.pro/overall-program.php>, and in the program book in the appendix.

Virtual Conference Platform

The virtual platform REMO (www.REMO.co) performed well. This platform allowed for networking each day, both before the sessions and at the noon break on day 2. The essence of the networking were several rooms with virtual tables, at which attendees could sit. Attendees could move from table to table as desired. Each attendee had an avatar, or miniature image, notated with that persons name and job information. See the networking room image in the appendix.

At the end of the networking period, all attendees were taken to the virtual presentation space. Questions were asked through a chat feature. Only speakers and moderators were visible on the attendee's screen. Each session had a moderator and a facilitator who monitored the chat boxes and monitored the questions that were being posed to the presenter.

Dry runs with the virtual platform were held one to two weeks before the conference for all speakers, moderators and facilitators, and were the key to the presentations going smoothly during the conference time.

Other platforms reviewed were Airmeeet, Guidebook and Accel Events. REMO had the best cost structure and capabilities for our needs. Teams had been used for the several nearby sections. Several 2021 committee members attended REMO section meetings, and were impressed with its networking abilities.

REMO's networking lounges got good reviews and attendees enjoyed the experience based on feedback received. It was noted that it took a bit to get familiar but after navigating to a session, they quickly got the hang of it.

ASHE 2021 National Conference
May 25 - 27, 2021
Final Report

One factor contributing to the success of the REMO platform was the amount of preparation done by the conference leadership. Several committee members attended the New Jersey sections' REMO meetings. Dry runs (mentioned above) and attention to the visual appearance helped keep things running smoothly. Sponsor logos and links were added, and multiple tracks were coordinated within the REMO structure. All this took time, and was begun two months before the conference.

The cost for the REMO platform was \$3,315, which accommodated the large number of participants and the multiple simultaneous sessions.

An instructional video was prepared to assist participants on the logistics of the event and REMO platform which was shared with attendees ahead of time – this video was viewed over 450 times, so it likely provided some helpful content.

Several guides were prepared for attendees, presenters, and moderators. These are in the appendix.

Technical presentations

The conference hosted three concurrent tracks (Planning & Design, Innovation, Construction)

Daily technical program schedule:

- 1pm-2pm – 5/25/2021 (Wednesday)
- 10am-2pm – 5/26/2021 (Thursday)
- 10am-noon – 5/27/2021 (Friday)

Sessions*:

- 14 – Full Sessions
- 5 – Half Sessions

* All but one session were presented live.

Call for Papers:

We received over 50 responses to the "Call for Papers" which was initially advertised in the Summer & Fall *scanner* issues, on ASHE National web site, social media and e-blast to membership with reminders. We also advertised in the International Bridge Conference (IBC) newsletter and reached out to TRB and the National Association of Environmental Professionals to promote.

Keynote Speaker:

Keynote speaker (Yassmin Gramian, Pennsylvania's Secretary of Transportation) was confirmed early for the original conference dates and venue and she was able to accommodate the change to May and to a virtual platform.

ASHE 2021 National Conference
May 25 - 27, 2021
Final Report

Presentations

The technical agenda website page was enhanced to provide a picture related to session (as available), biographies of the speakers and links to each speaker's LinkedIn page. This allowed interested participants to contact speakers directly.

Sessions were recorded to allow for viewing after the conference. Recorded sessions remain on the ASHE National YouTube channel along with contact information of the speakers. Professional Development Hours (PDH) were available for most sessions, with PDH questionnaires being used to confirm attendance and participation.

Each technical committee had a moderator and a Q&A facilitator during the event. These individuals allowed the presenter(s) to focus on the presentation, while volunteers took care of logistics. In addition, there was an event manager for each track each day to assist with bringing speakers to the virtual stage and facilitating the session (clearing old previous session chat and Q&A). This all worked well. Text messages between the group happened in the background to alert of any issues and moderators/Q&A had individual text messages with their speakers to alert of any issues/end time notifications.

There were seventeen professional development hours (PDHs) available.

A total of seven hundred eight PDHs were awarded.

Key documents used for planning and operations are included in the appendix.

Lightning round sessions

There was one "lightning round" consisting of three related presentations within a 50 minute period. This was to accommodate shorter presentations that had value to the attendees, but didn't fill an 50 minute session.

Lessons Learned:

- One speaker backed out of the lightning session with no notification, we were able to fill the slot – but it was very late in the process. Triple check on speakers as you get a month out from the event to ensure all are still willing and able to present.
- Too many emails – with the shift to the virtual, speakers were inundated with emails. Streamlining efforts could have included more thought process before sending emails or offering a forum to sign onto to get instruction.
- REMO – speaker privileges got removed at times which required fast action to get them added back in for the sessions. An overall REMO coordinator was able to add privileges quickly.
- Having redundancy (moderator and different Q&A facilitator) proved helpful with some technical issues during the sessions and having to switch roles.
- Two sessions were not recorded despite redundant efforts.
- Technical sessions were uploaded to ASHE National YouTube page.
- Post-production editing of the sessions took longer than expected due to rendering – used video editor software – is there a faster way?
- A Microsoft form was created for PDHs for each session – made it easy to fill out.
- ASHE Social Media promoted the conclusion of the conference and recordings.
- PDH's were issued the week of June 21, after the conference.

ASHE 2021 National Conference
May 25 - 27, 2021
Final Report

- National raised an issue with recorded sessions and offering PDHs to people who didn't attend the conference – we cross checked PDH forms against attendance.

Entertainment

Because of the virtual nature of the event, there was no entertainment.

Budget

A budget was prepared for the conference, but it was challenging to predict the attendance. In the end, the registration fee was determined more on a reasonable fee for a virtual conference rather than budgetary needs. With nearly twenty PDHs available, we felt that the \$50 registration fee for ASHE members gave attendees a good value for the payment. A fee of \$100 was set for non members, and government employees and students were \$35. Speakers and sponsors were complimentary.

Expenses were minor, except for the REMO fee and the registration gift to participants. We were able to return seed money to the three sections and to National, and carry about \$15,000 to the 2025 conference.

Appendix

- *scanner* advertisement
- Call for Papers
- Registration statistics
- Sponsorship package
- Program book package
- REMO package & guides
- Technical presentation summary
- Final Income / Expense report



2021 National Conference

A Gateway to Transportation Adventures



WATCH VIDEO

June 9 to 13

Kalahari Resort

Pocono Manor, PA



The three ASHE sections of eastern Pennsylvania invite you to the 2021 ASHE National Conference in the beautiful Pocono Mountains, at the exciting Kalahari Resort, with its famous indoor water park! Home to five previous national conferences, we return to this region famous for its resorts, natural scenic beauty, and quaint, historic towns. Join us as over 500 highway and transportation professionals and guests gather for four days of fellowship and learning. Visit our website and look to future *scanner* issues for more details.

2021conference.ashe.pro



ASHE
Delaware Valley



ASHE
East Penn



ASHE
North East Penn

ASHE NATIONAL CONFERENCE POCONOS, PA | JUNE 9-13, 2021

CALL FOR PAPERS!

DEADLINE:
OCTOBER 30, 2020



A GATEWAY TO
TRANSPORTATION ADVENTURES

AMERICAN SOCIETY OF HIGHWAY ENGINEERS 2021 NATIONAL CONFERENCE

The ASHE Technical Program is seeking abstracts for presentation at the 2021 Conference. Our theme is "A Gateway To Transportation Adventures."

We encourage innovative, educational and informative topics related to project phases for all transportation modes, including: Planning and Innovation, Environmental, Design and Construction.

*NEW at this conference! Lightning Presentations; this format will include six different speakers in one session time slot (60 mins), each speaking for seven minutes.

Each submitted abstract must be in English, fit on one page and include:

- Topic: General presentation description
- Presentation Abstract: 250 words maximum
- Contact: Presenter's name, company, address, phone number, email address
- Preferred Duration of Presentation: 7 mins (Lightning*); 20-25 mins (1/2 cr); 45-50 mins (1 cr)
- Name Your Abstract: 2021ASHE-(yoursurname)-Topic (Example: 2021ASHE-Smith-Connected_Vehicles)

Submit Abstracts by 10/30/20:
2021asheconference@gmail.com

For more information, visit: <http://2021conference.ashe.pro/>

ASHE 2021 conference Registration



Category	Count
Student / Government	60
Complimentary	163
Paid - members	174
Paid - non members	9
Total	406

Attendance

Tuesday, May 25	233
Wednesday, May 26	310
Thursday, May 27	256
of attendees recorded*	310

* participation over ten minutes

PadFolio Registration Gift





May 25 - 27, 2021

American Society of Highway Engineers

2021 National Conference (Virtual)

May 25 - 27, 2021

John Caperilla
Co-Chair
JCaperilla@mctish.com

Richard Cochrane
Co-Chair
2021Conference@ashe.pro

Todd Rousenberger
Co-Chair
trousenberger@rkk.com

Treasurer
Mark Boris
mboris@borton-lawson.com

Sponsorship Chair
Mark Kinnee
makinnee@urbanengineers.com

Technical Chair
Amanda Schumacher
ASchumacher@borton-lawson.com

Exhibit Chair
Frank Summa
fsumma@gpinet.com

Program Chair
Richard Ames
richard.ames@wsp.com

Registration & Reception Chair
Christine Frey
cfrey@trafficpd.com

Entertainment Chair
Jeff Obrecht
jobrecht@rkk.com

Publicity Chair
James Stanton
jstanton@trafficpd.com

Golf Chair
Dominic Yannuzzi
dyannuzzi@benesch.com

Transportation Chair
Butch Frati
bfrati@wilkes-barre.pa.us

Guest Program Chair
Jay McGee
jmccgee@HNTB.com

Transportation Industry Colleagues:

The three Eastern Pennsylvania Sections of the American Society of Highway Engineers (ASHE) are honored to host the 63rd Annual National Conference Virtually from May 25-27, 2021. As we present *ASHE: A Gateway to Transportation Adventures*, we anticipate that this event will attract public-and private-sector design professionals, vendors, contractors, and guests from across the country.

The National Conference plays a critical role in supporting ASHE's mission by providing a forum to promote a safe, efficient, and sustainable transportation system. The mission is achieved through education and fellowship opportunities while fostering innovation for the future of transportation. Although we will not be able to have the social events and tours that we have been accustomed to in the past, the agenda will contain informative technical sessions and networking opportunities through virtual chatrooms.

In order to make this event a success, we need the support of the Transportation Community. Several sponsorship levels were developed to meet a broad range of budgets so that your organization can be recognized as an industry partner, furthering the goals of ASHE. On behalf of the Conference and Planning Committee, we ask that your company consider becoming a sponsorship partner of the Conference. Please contact our Sponsorship Committee Chair for additional information on our sponsorship opportunities.

Mark Kinnee, PE, Sponsorship Committee Chair

Email: makinnee@urbanengineers.com or phone: (215) 284-3124

Sincerely,

Handwritten signature of John Caperilla in black ink.

John Caperilla
Conference Co-Chair

Handwritten signature of Richard Cochrane in black ink.

Richard Cochrane
Conference Co-Chair

Handwritten signature of Todd Rousenberger in black ink.

Todd Rousenberger
Conference Co-Chair



American Society of Highway Engineers

2021 National Conference (Virtual)

May 25 - 27, 2021

May 25 - 27, 2021

Conference Sponsorships

- Keynote sponsor \$1,500 (one)*
 - Four complimentary registrations
 - Special recognition at the keynote address at the opening session.
 - Larger logo with link on conference web site
 - Larger logo with link on all virtual events
 - Larger logo (with link on digital version) included on a full page ad featuring all sponsors in one *ASHE scanner* issue.
- Sustaining sponsor - \$1,000 (no limit)
 - Four complimentary registrations
 - Large logo with link on conference web site
 - Large logo with link on all virtual events
 - Large logo (with link on digital version) included on a full page ad featuring all sponsors in one *ASHE scanner* issue.
- Conference sponsor - \$500 (no limit)
 - Two complimentary registrations
 - Medium logo with link on conference web site
 - Medium logo with link on all virtual events
 - Medium logo (with link on digital version) included on a full page ad featuring all sponsors in one *ASHE scanner* issue.
- Virtual table sponsor - \$250 - (limit 20)*
 - One complimentary registration
 - Sponsor's name on a virtual table at all networking sessions, with a seat at a virtual table with whiteboard

Tables have eight virtual seats and whiteboard capability. Those seated at a table form a mini-video conference group. Attendees can move from table to table to interact with table sponsors.

**Exclusive Sponsorship Opportunities are on a first come, first serve basis. Payment must be made within 30 days of sign up for exclusive sponsorships, otherwise the Sponsorship Committee reserves the right to advertise the Sponsorship Opportunity.*



American Society of Highway Engineers

2021 National Conference (Virtual)

May 25 - 27, 2021

May 25 - 27, 2021

PAYMENT METHOD

Make checks payable to 2021 ASHE National Conference.
Checks must be received by April 16, 2021 in order to be recognized in the program book.

TOTAL DUE \$: *Please mark one box* *Check enclosed* *Online Payment**

AUTHORIZED SIGNATURE: _____

PRINT NAME:

TITLE:

ADDRESS:

SIGNATURE DATE:

EMAIL:

Please send this form along with payment to:

Urban Engineers, Inc.

ATTN: Mark Kinnee

530 Walnut Street

Philadelphia, PA 19106

For additional payment information, contact:

Mark Kinnee, PE

(215) 284-3124

makinnee@urbanengineers.com

*Use the following link for online payment: <http://www.2021conference.ashe.pro/payment-page.php>

ASHE National Conference
2021
Potential Sponsors

Business Name	Contact First	Contact Last	Email
A. Morton Thomas & Associates, Inc.	Kyle	Rankin	krankin@amtengineering.com
A.D. Marble & Company, Inc.	Peter	Dodds	pdodds@admarble.com
Acheulean Consulting	Jason	Flay	acheuleanconsulting@gmail.com
Advanced Drainage Systems, Inc.	John	Hunter	john.hunter@ads-pipe.com
AECOM	Craig	Suhoskey	craig.suhoskey@aecom.com
AI Engineers			bseeger@aiengineers.com
Alfred Benesch & Company	John	Eagan	jeagan@benesch.com
American Concrete Pavement Association	John	Becker	jbecker@pavement.com
American Engineers Group, LLC	Vijay	Gupta	vgupta@aegroup-llc.com
American Geotechnical & Environmental Services, Inc.	K. P.	Chopra	KPChopra@agesinc.com
Arora and Associates	Glenn	Deppert	gdeppert@arorapc.com
Arrow Land Solutions, LLC	Ed	Engle	eengle@arrowls.com
ASC Group Inc.	Shaune	Skinner	sskinner@ascgroup.net
ASHE Delaware Valley			
ASHE East Penn			
ASHE NE Penn			
ATCS	Jack	Cramer	jcramer@atcsplc.com
AWK Consulting Engineers, Inc.	Errol	Abdulla	abdullae@awkengineers.com
Beech Construction, Inc.	Michael	Beech	secure.mabeech@mabeech.com
Bergmann Associates	George	Kevgas	gkevgas@bergmannpc.com
Boles, Smyth Associates, Inc.	Michael	Boles	mcboles@bolessmyth.com
Borton Lawson Engineering	Mark	Boris	mboris@borton-lawson.com
Brayman Construction Corporation	Tim	Taylor	t_taylor@braymanconstruction.com
Buchart Horn	Mark	Karolski	mkarolsky@bh-ba.com
Burns Engineering	Erica	Antoine	eantoine@burns-group.com
C.C. Johnson & Malhorta P.C.	Chick	Babcock	cbabcock@ccjm.com
Cardno	Randy	Seaver	randy.seaver@cardnoTBE.com
Carroll Engineering Corporation	James	Graham	jgraham@carrollengineering.com
CDM Smith	Donald	Gusic	gusicd@cdmsmith.com
CDR Maguire	David	Snively	dave.snively@cdrmaguire.com
Century Engineering	Brian	Kisner	bkisner@centuryeng.com
CHA Consulting, Inc.	Mike	Hurt	mhurt@chacompanies.com
CONTECH Engineered Solutions LLC	Daniel	Strickler	dstrickler@conteches.com
Dawood Engineering, Inc.	Bony	Dawood	bdawood@dawood.cc
Dewberry Engineers, Inc.	Mark	Geiser	mgeiser@dewberry.com
EADS Group, Inc.	Robert	Kunselman	rkunselman@eadsgroup.com
Earth, Inc.	Michael	Sydlik	msydlik@earthincorp.com
Erdman Anthony	Vince	Valovage	ValovageVS@erdmananthony.com
Fiocco Engineering	Joseph	Fiocco	joe@fioccoengineering.com
Foresight Construction Services, LLC	Maggie	Moore	mmoore@foresightcsllc.com
French Engineering	Millie	French	mfrench@frenchengr.com
GAI Consultants, Inc.	Ben	Allis	B.Allis@gaiconsultants.com
Gannett Fleming, Inc.	Francis	Eells	feells@gfnet.com
Geo-Explorers, Inc.	Tarek	Haider	thaider@geo-explorers.com
Gibson-Thomas Engineering Co., Inc.	Timothy	Bolden	tim.bolden@gibson-thomas.com
Gilmore & Associates, Inc.	Amy	Kaminski	akaminski@gilmore-assoc.com
GPD Group	Edward	Reese	ereese@gpdgroup.com
Greenman-Pedersen, Inc. (GPI)	Thomas	Rowader	trowader@gpinet.com
Gresham Smith	Analyne	Barlaan	analyne.barlaan@greshamsmith.com
GZA	Ernie	Hanna	ernest.hanna@gza.com
Hatch Mott MacDonald	Daryl	Brogan	daryl.brogan@hatchmott.com

ASHE National Conference
2021
Potential Sponsors

Business Name	Contact First	Contact Last	Email
HDR	William	Laird	william.laird@hdrinc.com
Herbert Rowland & Grubic, Inc.	Stephen	Shimko	sjshimko@hotmail.com
Hill International, Inc.	Vic	Spinabelli	vicspinabelli@hillintl.com
HNTB Corporation	Jay	McGee	jrmcgee@hntb.com
HRV Conformance Verification Associates, Inc.	H. Rochelle	Stachel	hrstachel@hrvinc.com
Imperial Traffic & Data Collection	Bill	Hitchens	phitchens@imperialtdc.com
Inframap	John	Midyette	
Jacobs Engineering	Jay	Roth	jay.roth@jacobs.com
James J. Anderson Construction Co., Inc.	Robert	Crawford	bobc@jjaconstruction.com
JBC Associates, Inc.	Janet	Cunningham	janetc@jbcassociates.com
Johnson, Mirmiran & Thompson, Inc. (JMT)	James	Maloney	jmaloney@jmt.com
KCI Technologies, Inc.	Paul	McNamee	paul.mcnamee@kci.com
Keller Engineers	Thomas	Morisi	tmorisi@keller-engineers.com
Keystone Acquisition Services	Jay	Broadbent	jay@keystoneacquisitions.com
Kimley Horn	Matt	Shinton	matt.shinton@kimley-horn.com
Kittelson & Associates	Andrew	Duerr	aduerr@kittelson.com
KMJ Consulting, Inc.	Karen	Jehanian	kjehanian@kmjinc.com
KS Engineers PC	Kamal	Shahid	kshahid@kseng.com
KTA Tator, Inc.	Kimmer	Cline	kcline@kta.com
L&V Engineering, LLC	Jacinta	Vrabel	jvrabel@landveng.com
L.R. Kimball	Ed	Jones	ed.jones@lrkimball.com
LaBella Associates	John	Pocius	jpocius@labellapc.com
Lane Construction Company	Dennis	Luzier	daluzier@laneconstruct.com
Langan Engineering	AnnMarie	Vigilante	avigilante@langan.com
Larson Design Group	Max	Inkrote	minkrote@larsondesigngroup.com
Lexis Group	Alexis	Isenberg	aisenberg@thelexisgroupllc.com
Lochner	Ryan	Gargan	rgargan@hwlochner.com
Loftus Construction, Inc.	Jeffrey	Given	jgiven@loftusconstruction.com
Lotus Environmental Consulting, LLC	Katherine	Farrow	kfarrow@lotusenvironmental.com
Mackin Engineering Company	Tom	Riester	TER@mackinengineering.com
Malick & Scherer, P.C.	Arif	Malick	amalick@malickandscherer.com
Markosky Engineering Group	Apryle	Davis	adavis@markosky.com
McClane Associates	Tom	McClane	tmclane@mclaneassociates.com
McCormick, Taylor & Associates	Michael	Maholick	mamaholick@mccormicktaylor.com
McKim & Creed	Marianne	Boucher	mboucher@mckimcreed.com
McMahon Associates, Inc.	Casey	Moore	casey.moore@mcmtrans.com
McTish, Kunkel & Associates	Tim	Benner	tbenner@mctish.com
Mead & Hunt	Brittany	Williams	brittany.williams@meadhunt.com
Michael Baker International	Eric	Frary	efrary@mbakerintl.com
Modjeski and Masters, Inc.	B.T.	Martin	btmartin@modjeski.com
Moffatt & Nichol	Tim	Reid	treid@moffattnichol.com
Monaloh Basin Engineers	Massy	Paul	massypaul@mbe-eng.com
MS Consultants, Inc.	Sean	Sawford	ssawford@msconsultants.com
Navarro & Wright	John	Smith	jsmith@navarrowright.com
NTM Engineering, Inc.	Donna	Newell	dnewell@ntmeng.com
Nyeleve Bridge Corp.	Dominic	Girondo	mgirondo@schultzorg.com
P. Joseph Lehman Inc.	Marty	Malone	mmalone@lehmanengineers.com
Parsons	Joe	DiFiore	Joe.DiFiore@parsons.com
Peirce Engineering, Inc.	John	Peirce	jpeirce@peirceengineering.com
Pennoni Associates, Inc.	John	Zarsky	jzarsky@pennoni.com
Pennsy Supply	David	Tavaris	david.tavaris@oldcastlematerials.com

ASHE National Conference
2021
Potential Sponsors

Business Name	Contact First	Contact Last	Email
Pennsylvania Asphalt Pavement Association	Charlie	Goodhart	cgoodhart@pa-asphalt.org
Pennsylvania Concrete Pipe Association	Rex	Busa	rbusa@concretepipe.org
Permatile Concrete Products Company	Mimi	Coles	mcoles@permatile.com
Pickering Corts & Summerson, Inc.	John	Wilhelm	jwilhelm@pcs-civil.com
Powell, Trachtman, Logan, Carrie & Lombardo	Frederick	Brehm	fbrehm@powelltrachtman.com
Prime AE Group, Inc.	Kumar	Buvanendaran	kumarb@primeeng.com
Proforma Albreht & Co	Peggy	Johns	pjohns@brilliantpromotions.com
Promatech, Inc.	Carrie	Streahle	cstreahle@promatech.com
Prudent Engineering	Robert	Sanders	rsanders@prudenteng.com
PSI, Inc.	Steve	Simonette	steve.simonette@psiusa.com
Quality Engineering Solutions, Inc.	Sherry	Morian	smorian@QESpavements.com
Ramey Kemp	Justine	D'Andrea	jdandrea@rameykemp.com
Reilly Associates, inc.	Karen	Reilly	kreilly@reillyengineering.com
Remington, Vernick & Beach Engineers	Isaac	Kessler	isaac.kessler@rve.com
Rettew Associates, Inc.	Juli	Wolfe	juli.wolfe@rettew.com
Richard Grubb & Associates	Richard	Grubb	rgrubb@rgaincorporated.com
RIG Consulting	Sharmon	Winters	swinters@rig-consulting.com
RT Environmental Services Inc.	Gary	Brown	gbrown@rtenv.com
Rue Environmental	David	Rue	davidrue@rueenv.com
Rummel Klepper & Khal	Todd	Rousenberger	trousenberger@rkk.com
Rybinski Engineering	Mike	Mogan	mike.mogan@rybinski.com
SAI Consulting Engineers, Inc.	Mark	Bonner	mbonner@saiengr.com
Schnabel Engineering	Jeremy	Brown	jbrown@schnabel-eng.com
Skelly and Loy, Inc.	Sandra	Basehore	sbasehore@skellyloy.com
Specialty Engineering, Inc.	Leon Lung-Yan	Lai	lylai@sei-engineers.com
Stahl Sheaffer Engineering LLC	Mike	Marso	mmarso@sse-llc.com
Stambaugh Ness P.C.	Scott	Hursh	shursh@stambaughness.com
Stantec	Michael	Bougher	mike.bougher@stantec.com
Stell	Cyndi	Bardman	cbardman@stelllee.com
STV Incorporated	James	Brady	james.brady@stvinc.com
Sucevic, Piccolomini & Kuchar Engineering, Inc.	Perry	Schweiss	pschweiss@spkengr.com
Surveying and Mapping, LLC	Eric	Kaufman	eric.kaufman@sam.biz
Susquehanna Civil, Inc.	Rosanna	Smithnosky	rsmithnosky@sqcivil.com
T&M Associates	Donato	DiZuzio	ddizuzio@tandmassociates.com
T.W. Consultants, Inc.	Tasir	Wahlah	twahlah@twconsultants.com
T2 Utility Engineers	Jodi	Sabol	jodi.sabol@t2ue.com
Taylor, Wiseman & Taylor	Dennis	Moore	dmoore@taylorwiseman.com
Test	Richard	Cochrane	Rcochrane@ASHE.pro
The Fort Miller Co., Inc.	Dan	Moellman	dmoellman@super-slab.com
The Markosky Engineering Group, Inc.	Mark	Markosky	mmarkosky@markosky.com
Thornton Tomasetti, Inc.	Andrew	Hartmann	ahartmann@thorntontomasetti.com
Traffic Planning & Design	Robert	Prophet	rprophet@trafficpd.com
Trans Associates Engineering Consultants, Inc.	James	Prisk	Priskj@transassociates.com
TranSystems	Michael	Cuddy	mjcuddy@transystems.com
TRC Companies	Douglas	Massih	dmassih@trcsolutions.com
Trumbull Corporation	Kevin	Duris	Kevin.Duris@trumbullcorp.com
TY Lin International	Jill	Bolt	jill.bolt@tylin.com
Urban Engineers, Inc.	Mark	Kinnee	makinnee@urbanengineers.com
Van Cleef Engineering Associates	Anna	Petrov	apetrov@vancleefengineering.com
VE Engineering Inc.	Bea	Walters	walters@veengineering.com
VHB	Keith	Lewis	kdlewis@vhb.com
Volkert Inc.	Mike	Flack	mike.flack@volkert.com
Wallace Montgomery	Robert	Hudson	RHudson@wallacemontgomery.com
Walsh Construction Company	Steve	Thomas	sethomas@walshgroup.com
Whitman, Requardt & Associates, LLP	Robert	Wills	rwills@wrallp.com
Whitney, Bailey, Cox & Magnani, LLC	John	Prybella	jprybella@wbcm.com
WSP USA	Thomas	Friel	tom.friel@wsp.com



American Society of Highway Engineers

2021 National Conference (Virtual)

May 25 - 27, 2021

May 25 - 27, 2021

John Caperilla
Co-Chair
JCaperilla@mctish.com

Richard Cochrane
Co-Chair
2021Conference@ashe.pro

Todd Rousenberger
Co-Chair
trousenberger@rkk.com

Treasurer
Mark Boris
mboris@borton-lawson.com

Sponsorship Chair
Mark Kinnee
makinnee@urbanengineers.com

Technical Chair
Amanda Schumacher
ASchumacher@borton-lawson.com

Exhibit Chair
Frank Summa
fsumma@gpinet.com

Program Chair
Richard Ames
richard.ames@wsp.com

Registration & Reception Chair
Christine Frey
cfrey@trafficpd.com

Entertainment Chair
Jeff Obrecht
jobrecht@rkk.com

Publicity Chair
James Stanton
jstanton@trafficpd

Golf Chair
Dominic Yannuzzi
dyannuzzi@benesch.com

Transportation Chair
Butch Frati
bfrati@wilkes-barre.pa.us

Guest Program Chair
Jay McGee
jmcgee@HNTB.com

Transportation Industry Colleagues:

The three Eastern Pennsylvania Sections of the American Society of Highway Engineers (ASHE) are honored to host the 63rd Annual National Conference Virtually from May 25-27, 2021. As we present *ASHE: A Gateway to Transportation Adventures*, we anticipate that this event will attract public-and private-sector design professionals, vendors, contractors, and guests from across the country.

With this year's virtual conference, the program book will be a virtual as well. The format will be pdf, but the concept remains the same; the program will continue to be a valuable resource for all conference attendees and will include the conference schedule, information on the technical sessions, presenter's bios, and ASHE information.

With the virtual format, ASHE's production costs are lower and we are extending these lower costs to the advertising opportunities. We are featuring the Inside Front Cover as the second page in the program book. The full-page and half-page advertisements will be included throughout the book as formatting allows. Additionally, advertisers can provide web links to make their advertisement interactive. See the Program Book Advertising form for additional details.

Please consider supporting this conference and the mission of ASHE through an advertisement in the program book. On behalf of the Conference and Planning Committee, we ask that your company consider supporting the organization with an advertisement in the Program Book. Please contact our Program Committee Chair for additional information on our advertisement opportunities.

Richard Ames, PE, Program Committee Chair
Email: richard.ames@wsp.com or phone: (215) 208-8040

Sincerely,

John Caperilla
Conference Co-Chair

Richard Cochrane
Conference Co-Chair

Todd Rousenberger
Conference Co-Chair



PROGRAM BOOK ADVERTISING

PROGRAM BOOK ADVERTISEMENT OPPORTUNITIES

Inside Front Cover (Full Page) - **\$500**

Full page - **\$250**

Half page - **\$125**

Ad Size	Height	Width
Full page	10"	7.5"
Half page	4.5"	7.5"

Please send a high-resolution version of your advertisement or logo in .jpg, .png, .eps or .pdf format to Rich Ames at richard.ames@wsp.com. **All logos and advertisements must be received no later than April 16, 2021.**

COMPANY/ORGANIZATION: _____

CONTACT NAME: _____

ADDRESS: _____

CITY: _____ **STATE:** _____ **ZIP:** _____

PHONE: _____ **EMAIL:** _____

WEBSITE Link For Ad: _____

PAYMENT METHOD:

TOTAL DUE \$: _____ Please select one:

*Online Payment**

Check enclosed

Make checks payable to: 2021 ASHE National Conference

AUTHORIZED SIGNATURE: _____

PRINT NAME: _____

TITLE: _____

SIGNATURE DATE: _____ **EMAIL:** _____

For Online Payments: <http://www.2021conference.ashe.pro/payment-page.php>

Send this form along with payment to: 2021 ASHE National Conference
Attn: Rich Ames
WSP
Four Penn Center, Suite 510
1600 JFK Boulevard
Philadelphia, PA 19103

For additional information, contact: Rich Ames at 215-208-8040 or richard.ames@wsp.com

Visit <http://www.2021conference.ashe.pro> for more information

REMO Virtual Conference Platform

- Networking Room
- Speaker's Guide
- Attendee's Guide
- Event Manager Guide
- Technical Presentation Summary



Welcome to the 2021 ASHE National Conference



ASHE 2021 National Conference



Speaker's Guide

Thank you for contributing your time and efforts to make a technical presentation at the ASHE 2021 National Conference.

This guide will assist you in navigating our virtual conference platform.

We are using the REMO platform. You will find additional information at the REMO website - www.remo.co

The following steps will make your experience (and the experience of our attendees) much better.

Establish a REMO profile - <https://live.remo.co/signup>

This will allow you to join the conference. your profile may also contain additional information that others in attendance may view, including a profile photo or image. There is no charge to establish your profile.

Review the RMEO speaker's guide - This is a generic guide for speakers.

<https://help.remo.co/en/support/solutions/articles/63000240763-getting-started-as-a-speaker>

Register for the conference -

Contact our registration manager, Christine Frey, at cfrey@trafficpd.com regarding complimentary registration.

Gear Check

REMO will ask you to perform a "gear check", to ensure compatibility with your equipment. However, REMO appears to work with Windows 7 and Windows 8.1. If you get an error, simply skip the gear check. REMO should work as needed. REMO does NOT work with Internet Explorer.

Accept the invitations

In the week before the conference, you will receive an invitation by e-mail to the conference as a speaker. Click on the "Accept Invitation" button.

Important note: There are actually three events, one for each day. You will need to accept each invitation for days in which you are participating. You will also need to join the conference each day.

When it's time to join the meeting, you can use the link provided in the invitation e-mails.

Join the conference

Upon entry on the networking floor, you will be placed at a random table. You can move to another table by double-clicking on the new table. You can also move from floor to floor with the elevator. **You will need to rejoin the conference each day.**



This is the networking, or main, floor.

Prepare to present - move to your track

As your time to present approaches, move to the appropriate track for your presentation, using the links in the top-right margin.



Timing

Timing is critical to coordinate the tracks. Presentations will begin on the hour, and will automatically end at 50 minutes past the hour. You have 50 minutes for the presentation and questions and answers.

You will now be in another networking area, but in your selected track. Note that you can return to the main floor or lobby as well. To jump to another track, return to the main lobby and then navigate to your selected track.

If you jump to a track late, you will be placed in the presentation area directly.

Your presentation

At the appropriate time on the hour, the event manager will move everyone to the presentation area:



In this area - the virtual stage - you will see images of all the people on stage. If you have slides, such as a power point, you will show them using the "Share" button to share your screen. You can share the active screen or you can share a window on your local computer. You will be given a choice of the share.

If you are on stage, but not participating, please hide yourself by muting your camera and microphone. **We are limited to ten people on stage at a time.** You will, however, be able to see and hear everyone on stage. When it's your turn to present, simply turn your microphone and camera on.

In the event of a microphone or camera error, simply refresh your browser. You will return to the presentation.

Note that the audience can not be seen nor heard in the presentation mode.

End of technical session

When the session ends, you will automatically be returned to the track networking floor by the event manager.

Navigate to the main floor or remain in the track.

On day three, you must return to the main lobby for the award and closing ceremony. The track lobbies will be closed.

Hints:

- If you have trouble, refresh your browser. You will go back to where you left off.
- To leave the stage, simply mute your camera and microphone. You will be able to see and hear the presentations.
- If you get lost, simply return to the main lobby. If you really get lost, simply rejoin the conference using the invitation for the appropriate day.
- Be patient. With almost 300 attendees, it may take a few seconds for you to get on stage.
- Try to attend an open house on May 18 or May 20 to experience the platform first hand.
- Problems - reach out to Amanda Schumacher (2021conference@yahoo.com) or the conference committee (2021conference@asahe.pro) or the conference help desk (2021HelpDesk@ashe.pro)

Thank you

The Conference Committee



ASHE 2021 National Conference

Attendee's Guide



Thank you for joining the ASHE 2021 National Conference.

This guide will assist you in navigating our virtual conference platform.

We are using the REMO platform. You will find additional information at the REMO website - www.remo.co

The following steps will make your experience (and the experience of our attendees) much better.

Establish a REMO profile - <https://live.remo.co/signup>

This will allow you to join the conference. Your profile may also contain additional information that others in attendance may view, including a profile photo or image. There is no charge to establish your profile.

Register for the conference -

The fact that you are reading this indicates that you have registered.

You must join using the same e-mail address you used in your registration.

Gear Check

REMO will ask you to perform a "gear check", to ensure compatibility with your equipment. However, REMO appears to work with Windows 7 and Windows 8.1. If you get an error, simply skip the gear check. REMO should work as needed. REMO does NOT work with Internet Explorer.

Accept the invitations

In the week before the conference, you will receive an invitation by e-mail to the conference as a speaker. Click on the "Accept Invitation" button.

Important note: There are actually three events, one for each day. You will need to accept each invitation for days in which you are participating. You will also need to join the conference each day.

Here's your private access link to join Sample-Invitation!

I'm hosting this special event on an amazing, interactive online platform: Remo Conference.

To get all the important details, click the button below.

Accept the invitation

Accept My Invitation

I'm excited to have you join me!
Richard Cochrane - 2021

Please check your settings are compatible with our gear test here:

Check your equipment*

Check settings

P.S. If the button above doesn't automatically redirect you to the registration page, please copy and paste this link into your browser:
<https://live.remo.co/a/c6ebaa9409832ba497308de02b53d04b>

[Unsubscribe](#) - [Unsubscribe Preferences](#)

2021 ASHE National Conference has invited you to Sample-Invitation - 2021 ASHE National Conference

Title: Sample-Invitation - 2021 ASHE National Conference
Location: <https://live.remo.co/a/c6ebaa9409832ba497308de02b53d04b>
When: Monday, May 17, 2021 9:30 AM – 10:30 AM
Organizer: 2021 ASHE National Conference <noreply@remo.co>
Description: You can enter this event from your computer.
Join event: <https://live.remo.co/a/c6ebaa9409832ba497308de02b53d04b>
Attendees: You <rc803@comcast.net>
Related Link: <https://live.remo.co/a/c6ebaa9409832ba497308de02b53d04b>

Link to join conference

Sample invitation

When it's time to join the meeting, you can use the link provided in the invitation e-mails.

Join the conference

Upon entry on the networking floor, you will be placed at a random table. You can move to another table by double-clicking on the new table. You can also move from floor to floor with the elevator. **You will need to rejoin the conference each day.**



This is the networking, or main, floor.

Time for the technical programs - move to a technical track

As your time to present approaches, move to the appropriate track for the presentation of your choice, using the links in the top-right margin.

Note: The overall program can be found in the electronic program book or at our web site:

<http://www.2021conference.ashe.pro/overall-program.php>



Technical Session



In this area - the virtual stage - you will see images of all the presenters on stage. If the presenter has a slide show or video, it will also be here.

The chat window can be opened with the blue tab on the left side of the screen. The chat window will allow you to chat with others. It also allows you to ask questions.

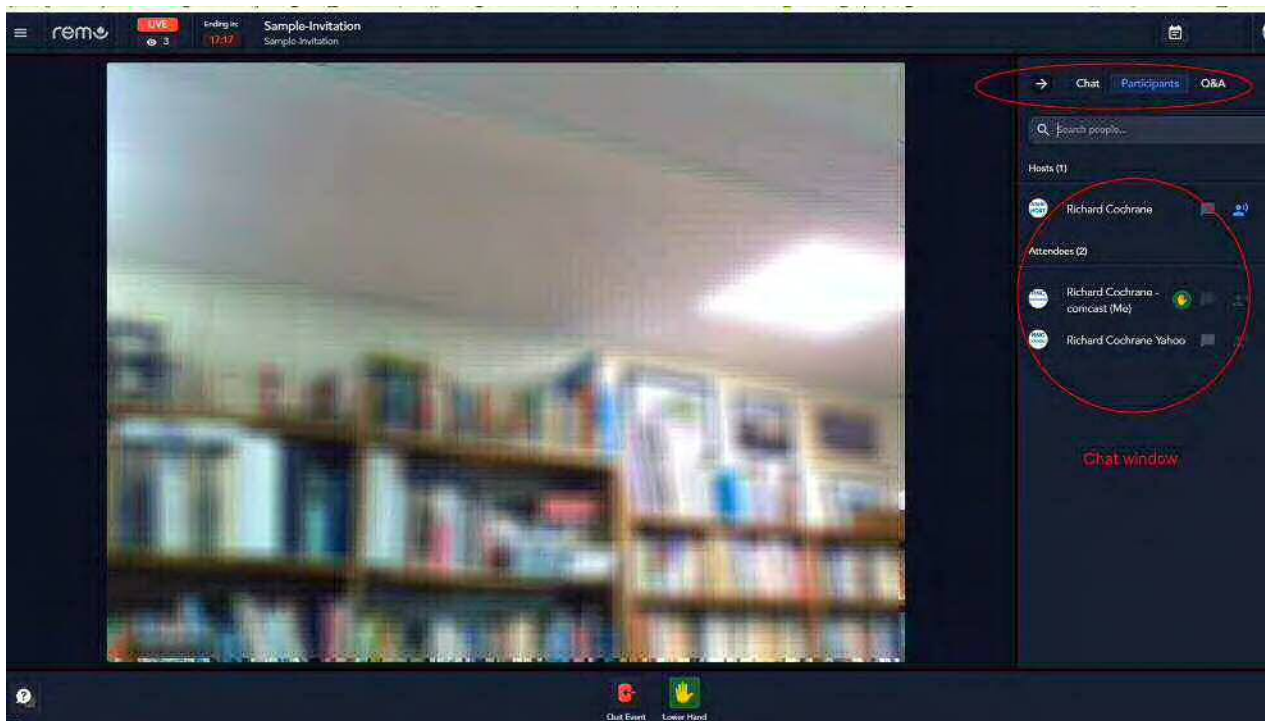

As a guest, you can not be seen nor heard in the presentation mode. However, the session host can bring a guest on stage if needed.

End of technical session

When the session ends, you will automatically be returned to the track networking floor by the event manager.

Navigate to the main floor or remain in the track. To navigate to another track, navigate to the main floor (main lobby) and then to the desired track.

On day three, you must return to the main lobby for the award and closing ceremony. The track lobbies will be closed.

Hints:

- If you have trouble, refresh your browser. You will go back to where you left off.
- If you get lost, simply return to the main lobby. If you really get lost, simply leave and rejoin the conference using the invitation for the appropriate day. You can then navigate to the track you desire.
- Be patient. With almost 300 attendees, it may take a few seconds for you to get on stage.
- Problems - reach out the conference help desk at 2021HelpDesk@ashe.pro

Thank you

The Conference Committee



ASHE 2021 National Conference

Event Manager Guide



Event manager's duties:

- Start and stop presentation as needed.
- Presentations should start on the hour and end 50 minutes past the hour.
- Make announcements as needed to attendees in the lobby, advising of upcoming changes
 - Prepare to move to the presentation area (five minutes prior)
 - Prepare to move to Main Lobby or Track as needed
- Move about Main Lobby greeting people

The details:

- On Tuesday, several minutes before the technical session starts, move to the appropriate track. You may need to use **direct navigation***
- On Wednesday and Thursday, move to the appropriate track upon arrival. (Fig 1)
- Once in the appropriate track, make announcements as appropriate. (Fig 2)
- Prepare to move to the presentation area. Speakers will move to the stage automatically. (Fig 3)
- **Set to record (Fig 4)**
- Once in the presentation area, the Event Manager will be on stage.
 - If you are a session monitor, introduce the speaker(s).
 - If you are not a session monitor, mute your camera and microphone
- At 50 minutes past the hour, move back to the Track Lobby. (Fig 5)
- If there is another presentation in the same track (Wednesday and Thursday mornings only), remain in the Track Lobby and wait to start the next session using the presentation start button.
- There are an agenda and a "run-of-show" that can assist in keeping track of everything. These are the movie clap board and the rolodex icons at the upper right. (Fig 6)

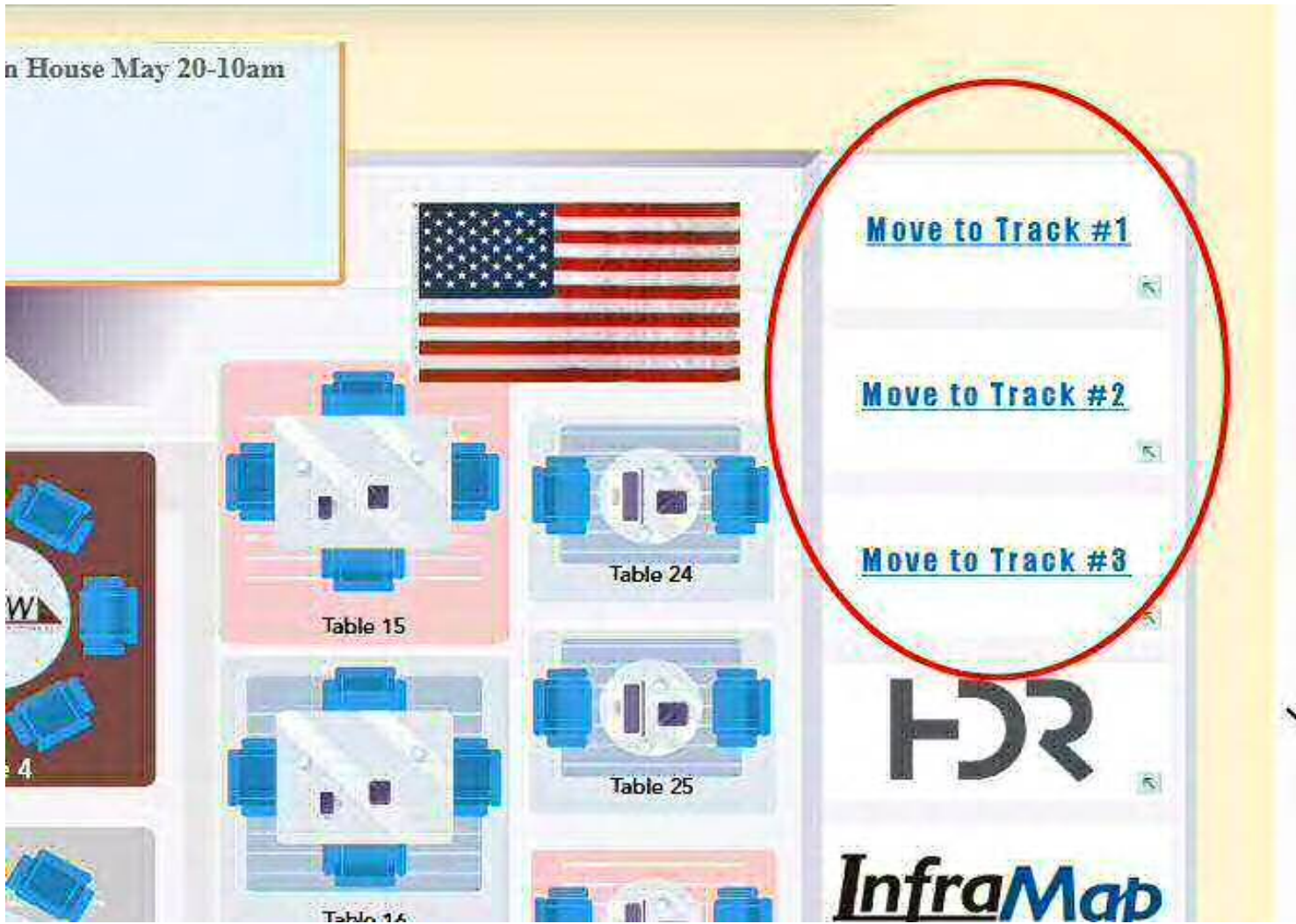

Figure 1 - Move to your track



Figure 2 - Make an announcement



Fig 3 - Move to presentation area



Fig 4 - Record the presentation

See below for bringing guests onto the stage

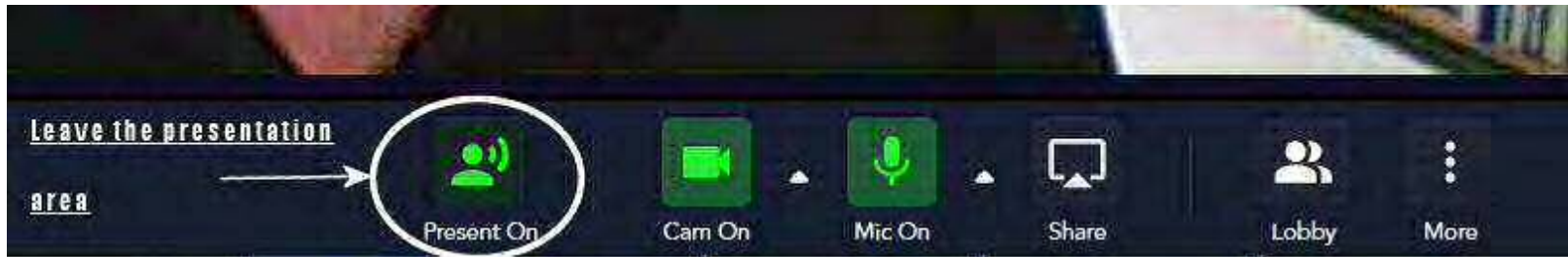

Fig 5 - End the presentation and return to the Track Lobby



Fig 6 - Agenda and Run-of-Show buttons

*** Direct navigation**

Use the following chart of URLs to navigate directly to a track or the main lobby. This is needed if you are in the presentation area, as the links are not visible.

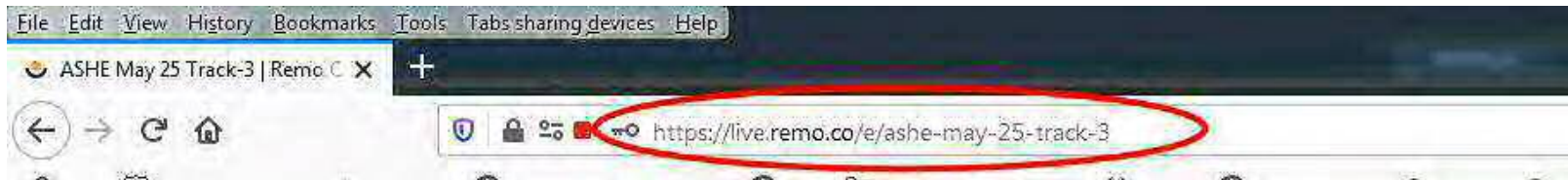

Date	Time	Track	Link to event
Tuesday May 25	11:00 am - 4:00 pm	Main Lobby	https://live.remo.co/e/ashe-national-conference-may-25/?autojoin=1
	12:45 pm - 4:00 pm	Track 1	https://live.remo.co/e/ashe-may-25-track-1/?autojoin=1
	12:45 pm - 4:00 pm	Track 2	https://live.remo.co/e/ashe-may-25-track-2/?autojoin=1
	12:45 pm - 4:00 pm	Track 3	https://live.remo.co/e/ashe-may-25-track-3/?autojoin=1
Wednesday May 26	9:00 am - 4:00 pm	Main Lobby	https://live.remo.co/e/ashe-national-conference-may-26-1/?autojoin=1
	9:00 am - 4:00 pm	Track 1	https://live.remo.co/e/ashe-may-26-track-1/?autojoin=1
	9:00 am - 4:00 pm	Track 2	https://live.remo.co/e/ashe-may-26-track-2/?autojoin=1
	9:00 am - 4:00 pm	Track 3	https://live.remo.co/e/ashe-may-26-track-3/?autojoin=1
Thursday May 27	9:00 am - 1:45 pm	Main Lobby	https://live.remo.co/e/ashe-national-conference-may-27/?autojoin=1
	9:00 am - 1:45 pm	Track 1	https://live.remo.co/e/ashe-may-27-track-1/?autojoin=1
	9:00 am - 1:45 pm	Track 2	https://live.remo.co/e/ashe-may-27-track-2/?autojoin=1
	9:00 am - 1:45 pm	Track 3	https://live.remo.co/e/ashe-may-27-track-3/?autojoin=1

https://youtu.be/od_LYvmYsv8

<https://www.youtube.com/channel/UCntTwnZuJOTisGXH0jR7S5A>

Prepare to present - move to your track

As your time to present approaches, move to the appropriate track for your presentation, using the links in the top-right margin. You may go to a track at any time, but if you end up in another session, please mute your camera and microphone. You will still be able to hear and see everything, but you will not contribute to our limit of ten people on stage at one time.



Timing

Timing is critical to coordinate the tracks. Presentations will begin on the hour, and will automatically end at 50 minutes past the hour. You have 50 minutes for the presentation and questions and answers.

You will now be in another networking area, but in your selected track.

Note that you can return to the main floor or lobby as well. To jump to another track, return to the main lobby and then navigate to your selected track.

If you jump to a track late, you will be placed in the presentation area directly.

Your presentation

At the appropriate time on the hour, the event manager will move everyone to the presentation area:



In this area - the virtual stage - you will see images of all the people on stage. If you have slides, such as a power point, you will show them using the "Share" button to share your screen. You can share the active screen or a window on your local computer. You will be given a choice of the share. **Using two monitors will make your presentation easier to control.**

If you are on stage, but not participating, please hide yourself by muting your camera and microphone. **We are limited to ten people on stage at a time.** You will, however, be able to see and hear everyone on stage. When it's your turn to present, simply turn your microphone and camera on.

In the event of a microphone or camera error, simply refresh your browser. You will return to the presentation.

Note that the audience can not be seen nor heard in the presentation mode.

End of technical session

When the session ends, you will automatically be returned to the track networking floor by the event manager.

Navigate to the main floor or remain in the track.

On day three, you must return to the main lobby for the award and closing ceremony. The track lobbies will be closed.

Hints:

- If you have trouble, refresh your browser. You will go back to where you left off.
- To leave the stage, simply mute your camera and microphone. You will be able to see and hear the presentations.
- If you get lost, simply return to the main lobby. If you really get lost, simply rejoin the conference using the invitation for the appropriate day.
- Be patient. With almost 300 attendees, it may take a few seconds for you to get on stage.
- Try to attend an open house on May 18 or May 20 to experience the platform first hand.
- Problems - reach out to Amanda Schumacher (2021conference@yahoo.com) or the conference committee (2021conference@asahe.pro) or the conference help desk (2021HelpDesk@ashe.pro)

Thank you

The Conference Committee

ASHE 2021 National Conference Technical Presentation Summary

25-May					26-May					27-May				
Session	Speakers-Contact	Track	Length		S-2	Speakers-Contact	Track	Length		S-5	Speakers-Contact	Track	Length	
					10-11am	Central Susquehanna Valley Thruway (CSVT) Northern Section Project	Barbara T. Hoehne, PE – STV Project Manager; cell phone (717) 512-1079	Design T-1	Full	10-10:30am	Closing a Critical Gap in the Schuylkill River Trail: Using Creative Engineering Solutions to Transform a Highway Bridge Into a Multi-Modal Bridge.	Michael Baker International 645 West Hamilton Street Suite 206 Allentown PA 18101 215-528-7072	Design T-1a	Half
					10-10:15am - Lightning - 1 of 3	MOUNTAIN PARKWAY Extension - Four Lane of US 460/Restaurant row, Kentucky Transportation Cabinet (KYTC)	David Kratt, PE	Innovation T-2A	LIGHTNING	10:30-11am	Complete Streets - Redefining Greensboro's Gateway	Adam Archual, Gannett Fleming, Inc., (984) 389-2398, aarchual@gfnet.com	Design T-1b	Half
					10:15-10:30 - Lightning - 2 of 3	The On-going challenge of a Seamless Mesh between Hydrographic Multibeam data, Terrestrial LIDAR Surveying, and Aerial/Mobile LIDAR Data Acquisition	Ivan Lineberry, LS	Innovation T-2B	LIGHTNING	10-11am	OpenBridge & OpenRoads – 3D Design & Real World FDOT Applications	Presenter's: David Lutz and Kali McNeil • Company: WGI	Innovation T-2	Full
					10:30-10:45am - Lightning - 3 of 3	Stites Tunnel: Replacing the Bridge Inside a Tunnel	Quentin D Rissler, PE	Construction T-2C	LIGHTNING	10-10:30am	You Want Me to Build What? (constructability)	Tamae Partain Atkins, Member of the SNC-Lavalin Group	Construction T-3a	Half
					10-11am	An ABC Success Story: Blackhall Road over Rum Creek	Thomas P. Karis, P.E.	Construction T-3	Full	10:30-11am	A Modern Truss for the 21st Century – The Pond Eddy Bridge Replacement Project	Gregory Soule SAI Consulting Engineers	Construction T-3b	Half
						S-3								
					11am-noon	One Corridor, Two Projects, A Common Vision: A review of the Empire State Trail	Kristie Di Cocco, PE Alta Planning + Design, Inc. Lindsay Zefting, PE Alta Planning + Design, Inc.	Design T-1	Full	11am-noon	PennDOT District Executive Panel & PTC	Rich Roman - D4 Chris Kufro - D5 Mike Rebert - D6 Mark Compton - PTC	Design T-1	Full
					11am-noon	Accelerated Bridge Construction- Integrating New Technologies in Bridge Construction	Eric A. Carleton, P.E. Director of Codes and Standards National Precast Concrete Association	Innovation T-2	Full	11am-noon	3D Utilities for a Successful and Cost Effective project	Evan Dailey KCI Technologies, Inc. Joseph Porter KCI Technologies, Inc. Cyrus McCall	Innovation T-2	Full
					11am-noon	I-84 Twin Bridges Project	Timothy S. Benner, PE	Construction T-3	Full	11am-noon	Urban Design-Build	Sean Milroy, P.E., PMP, DBIA Michael Baker Intl.om	Innovation T-3	Full
						S-4								
	S-1. T1 T-2 T-3													
1pm-2pm	Corner Design For All Users	Matt Pinder, M.Eng., EIT Kristie Di Cocco, PE Joe Gilpin	Design T-1	Full	1pm-2pm	Overcoming Foundation Challenges in Dual Highly Charged Aquifers	Eric Dues, PE, SE (Gannett Fleming Project Manager) HDR; Allen Melley PennDOT Bureau of Project Delivery Mark Chappel PennDOT Bureau of Project Delivery	Design T-1	Full					
1pm-2pm	Leveraging Technology to Optimize Operations	Presenter's Name: Heather Heeter & Walt Stout	Innovation T-2	Full	1pm-2pm	PennDOT Digital Delivery Directive 2025 – A Gateway to the Future of Project Delivery	Mahmood Shehata RK&K ; Ben Snyder RK&K Dan Farley PennDOT	Innovation T-2	Full					
1-1:30pm	Steel Dowel/Reinforced Concrete Retaining Wall Stabilizing System	Patrick Brown, P.E.	Construction T-3	Half	1pm-2pm	Automated Work Zone Speed Enforcement		Construction T-3	Full					

ASHE 2021 National Conference
Income Expenses
Final
January 31, 2022

Description	Number	Unit Cost	Income	Expense
Registration (Paid)	174	\$ 50.00	\$ 8,700.00	
Registration (Comp)	163	\$ 0.00		
Registration (Student / gov't)	60	\$ 35.00	\$ 2,100.00	
Registration - non ASHE	9	\$ 100.00	\$ 900.00	
Registration – PayPal fee (information)				(\$ 414.91)
Sponsorships				
Keynote Sponsor	1	\$ 1,500.00	\$ 1,500.00	
Sustaining sponsor (7 PP)	16	\$ 1,000.00	\$ 16,000.00	
Conference Sponsor (12 PP)	18	\$ 500.00	\$ 9,000.00	
Table Sponsor (2 PP)	4	\$ 250.00	\$ 1,000.00	
PayPal test donation	1	\$ 100.00	\$ 100.00	
Sponsorships - PayPal (21) (Information)				(\$ 503.70)
Program book ads ⁽³⁾				
Page 2 ad	1	\$ 500.00	\$ 500.00	
Full page ad (12 PP)	18	\$ 250.00	\$ 4,500.00	
Half page ad (1 PP)	7	\$ 125.00	\$ 875.00	
Advertisers – PayPal (13) (Information)				(\$ 101.78)
Donation from 2020	1	\$ 5,000.00	\$ 5,000.00	
Seed money - DelVal	1	\$ 1,000.00	\$ 1,000.00	
Seed money - East Penn	1	\$ 1,000.00	\$ 1,000.00	
Seed money - NE Penn	1	\$ 1,000.00	\$ 1,000.00	
Seed money - National	1	\$ 8,000.00	\$ 8,000.00	
Nat'l sponsorship Past Prex luncheon	1	\$ 4,000.00	\$ 4,000.00	
Refunds				
Howl at the Moon (Sat evening)	1	\$ 1,150.00	\$ 1,150.00	
Mt Airy Golf Club	1	\$ 350.00	\$ 350.00	
Deposits				
Kalahari Resort	1	(\$ 10,000.00)		(\$ 10,000.00)
Mt Airy Golf Club	1	(\$ 350.00)		(\$ 350.00)
Howl at the Moon (Sat evening)	1	(\$ 1,150.00)		(\$ 1,150.00)
Misc. expenses				
Shirts - purchase	41	(\$ 29.4002)		(\$ 1,205.41)
Shirts - mailing to Nat'l board	1	(\$ 111.30)		(\$ 111.30)
Adobe Illustrator - 2 months	2	(\$ 33.38)		(\$ 66.76)
Misc. graphics	1	(\$ 47.85)		(\$ 47.85)
Registration gifts (includes shipping)	390	(\$ 20.9964)		(\$ 8,188.61)
PayPal fees				
Forward to 2022	1	(\$ 5,000.00)		(\$ 5,000.00)
Nat'l sponsorship 2025 ⁽¹⁾	1	(\$ 4,000.00)		(\$ 4,000.00)
REMO	1	(\$ 3,315.00)		(\$ 3,315.00)
Bank fees	1	(\$ 24.00)		(\$ 24.00)
Return seed money - DelVal	1	(\$ 1,000.00)		(\$ 1,000.00)
Return seed money - East Penn	1	(\$ 1,000.00)		(\$ 1,000.00)
Return seed money - NE Penn	1	(\$ 1,000.00)		(\$ 1,000.00)
Return seed money - National	1	(\$ 8,000.00)		(\$ 8,000.00)
Program book printing	1	(\$ 384.99)		(\$ 384.99)
After-conference event	1	(\$ 1,311.48)		(\$ 1,311.48)
		Totals	\$ 66,675.00	(\$ 47,175.79)
		Net		\$ 19,499.21

Notes: 1. Past Prex Luncheon sponsorship

Profit > \$12,000	\$	7,499.21
50% to National	\$	3,749.61

ASHE

National Conference



May 25 – 27



Hosted by:





Sucevic, Piccolomini
& Kuchar Engineering, Inc.

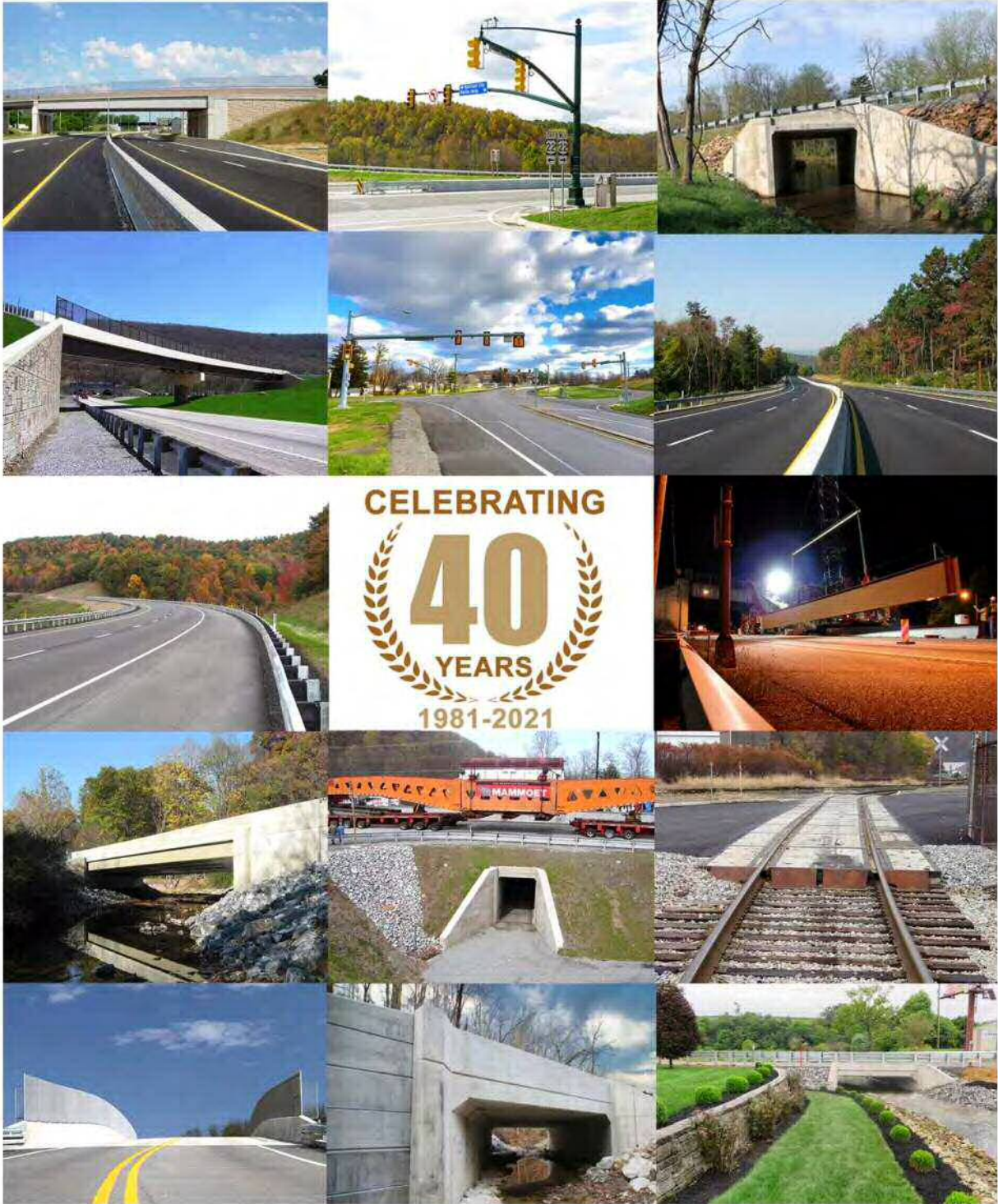

CELEBRATING
40
YEARS
1981-2021

www.spkengr.com | 724-439-1600



ASHE 2021 National Conference

May 25-27, 2021

2021 Conference Welcome Letter

Welcome to the virtual 2021 ASHE National Conference!

On behalf of all the volunteers who have worked on preparing and presenting the year's conference, we would like to invite you to enjoy the virtual networking and technical sessions we are presenting.

The industry has learned a lot about conducting business without physical presence and with on-line, computer-based video techniques. We have selected a platform, known as Remo, that will allow you to visit with fellow professionals in a small-group format with good quality audio and video. The only thing we can't provide are snacks and drinks. But you can still enjoy a level of camaraderie meaningful interaction that would have been impossible just a few months ago.

We also have a slate of technical presentations that will allow you to see what is going on across the country in our industry. In fact, without the limitations and restrictions of travel, we can offer a broader selection of presentations that we would normally be able to offer. You will have the ability to ask questions, see the presentations clearly, and receive credit for the sessions.

You will also have the opportunity to participate in ASHE business, as we present various project and honorary awards, and install directors and officers for the upcoming year.

We send a great big thanks to all the volunteers that quickly shifted from planning an in-person conference to a virtual one. Without these people, this would not have been possible. We also thank the National Board and the National Conference Committee for their faith in our ability to prepare and present a virtual conference.

We feel fortunate to be able to host this conference and provide a meaningful experience to you, our guests and fellow professionals.

John Caperilla
Conference Co-Chair

Richard Cochrane
Conference Co-Chair

Todd Rousenberger
Conference Co-Chair

2021 Conference Committee

John Caperilla
Co-Chair
JCaperilla@mctish.com

Richard Cochrane
Co-Chair
2021Conference@ashe.pro

Todd Rousenberger
Co-Chair
trousenberger@rkk.com

Treasurer
Mark Boris
mboris@borton-lawson.com

Sponsorship Chair
Mark Kinnee
makinnee@urbanengineers.com

Technical Chair
Amanda Schumacher
ASchumacher@borton-lawson.com

Exhibit Chair
Frank Summa
fsumma@gpinet.com

Program Chair
Richard Ames
richard.ames@wsp.com

Registration & Reception Chair
Christine Frey
cfrey@trafficpd.com

Entertainment Chair
Jeff Obrecht
jobrecht@rkk.com

Publicity Chair
James Stanton
jstanton@trafficpd.com

Golf Chair
Dominic Yannuzzi
dyannuzzi@benesch.com

Transportation Chair
Butch Frati
bfrati@wilkes-barre.pa.us

Guest Program Chair
Jay McGee
irmcaee@HNTB.com



ASHE 2021 National Conference

May 25-27, 2021

Table of Contents

2021 Conference Welcome Letter	i
Conference Program	2
Technical Program.....	4
Awards.....	20
Robert E. Pearson/Person of the Year Award Winner	20
Gene G. Smith Award	22
George Hart Award	26
Terence D. Conner Award	27
Robert E. Yeager Award	27
Lifetime Achievement.....	22
ASHE Member of the Year Award	24
Young Member of the Year Award.....	23
National President's Award	24
Under \$20M Project of the Year.....	29
Over \$20M Project of the Year.....	30
ASHE National Information.....	31
Conference Sponsors and Advertisers	35



ASHE 2021 National Conference

May 25-27, 2021

Conference Program

Legend for Technical Sessions

Track 1: Planning and design

Track 2: Innovation

Track 3: Construction

Tuesday, May 25

-
- 11:00 am - noon Pre-conference networking
- Noon - 1:00 pm ASHE Opening Session & Keynote Speaker
Yassmin Gramian, Secretary, Pennsylvania Dept of Transportation
- 1:00 pm - 2:00 pm Technical session #1
Track 1 - Corner Design For All Users
Track 2 - Leveraging Technology to Optimize Operations
Track 3 - Steel Dowel/Reinforced Concrete Retaining Wall Stabilizing System (½ session)
- 2:00 pm - 4:00 pm Networking

Wednesday, May 26

-
- 9:00 am - 10:00 am Pre-session networking
- 10:00 am - 11:00 am Technical session #2
Track 1 - Central Susquehanna Valley Thruway (CSVT) Northern Section Project
Track 2 Lightning session
- Lincoln Way Streetscape – Designing the Gateway to Downtown Massillon, OH
- The on-going challenge of a Seamless Mesh between Hydrographic Multibeam data
- Stites Tunnel: Replacing the Bridge Inside a Tunnel
Track 3 - An ABC Success Story: Blackhall Road over Rum Creek
- 11:00 am - Noon Technical session #3
Track 1-One Corridor, Two Projects, A Common Vision: A review of the Empire State Trail
Track 2 - Accelerated Bridge Construction- Integrating New Technologies in Bridge Construction presentation
Track 3 - I-84 Twin Bridges Project
- Noon - 1:00 pm Networking
Section/Region Officers' meeting (*This meeting is free and does not require registration*)
- 1:00 pm - 2:00 pm Technical session #4
Track 1 - Overcoming Foundation Challenges in Dual Highly Charged Aquifers
Track 2 - PennDOT Digital Delivery Directive 2025 – A Gateway to the Future of Project Delivery
Track 3 - Automated Work Zone Speed Enforcement
- 2:00 pm - 4:00 pm Networking



ASHE 2021 National Conference

May 25-27, 2021

Thursday, May 27

9:00 am - 10:00 am Pre-session networking

10:00 am - 11:00 am Technical session #5

Track 1A - Closing a Critical Gap in the Schuylkill River Trail: Using Creative Engineering Solutions to Transform a Highway Bridge into a Multi-Modal Bridge (½ session)

Track 1B - Complete Streets - Redefining Greensboro's Gateway (½ session)

Track 2 - OpenBridge & OpenRoads – 3D Design & Real World FDOT Applications

Track 3A - You Want Me to Build What? (½ session)

Track 3B - A Modern Truss for the 21st Century – The Pond Eddy Bridge Replacement Project (½ session)

11:00 am - Noon Technical session #6

Track 1 - PennDOT District Executive & Pennsylvania Turnpike Commission Panel Discussion

Track 2 - 3D Utilities for a Successful and Cost-Effective project

Track 3 - Urban Design-Build

Noon - 1:00 pm Installation of Officers & Awards ceremony

2:00 pm - 3:30 pm Past Presidents' Meeting (by invitation only)



ASHE 2021 National Conference

May 25-27, 2021

Technical Program

ASHE Opening Session – Tuesday, May 25, 12:00 pm

- Welcome Address - *Richard Cochrane, Conference Co-chair*
- Pledge of Allegiance - *Todd Rousenberger, Conference Co-chair*
- Remarks and Call to Order - *Tim Matthews, National President*
- Secretary's Report - *Tom Morisi, National Secretary*
- Report of Section Participation - *Tom Morisi, National Secretary*
- National Treasurer's Report - *Frank O'Hare, National Treasurer*
- Nominations For 2021 - 2022 Year - *Mike Hurtt, National Nominating Committee*
- Adjourn the Business Meeting - *Tim Matthews, National President*
- Introduction of Keynote Speaker - *Amanda Schumacher, Technical Programs Chair*
- Keynote Address - *Hon. Yassmin Gramian, Pennsylvania Secretary of Transportation*
- Conference logistics - *John Caperilla, Conference Co-chair*



ASHE 2021 National Conference

May 25-27, 2021

Keynote Speaker – Honorable Yassmin Gramian, PE, Secretary, Pennsylvania Department of Transportation



Ms. Gramian serves as the secretary of the Pennsylvania Department of Transportation. She was confirmed unanimously by Pennsylvania's Senate on May 27, 2020. As secretary, she oversees programs and policies affecting highways, urban and rural public transportation, airports, railroads, ports, and waterways. She manages PennDOT's annual budget of \$9.5 billion, which is invested in all of Pennsylvania's approximately 120,000 miles of state and local highways and 32,000 state and local bridges. Under her leadership, PennDOT is directly responsible for nearly 40,000 miles of highway and roughly 25,400 bridges. She also has oversight of the state's 11.8 million vehicle registrations and 10.3 million driver's licenses and IDs.

Ms. Gramian has more than 30 years of experience in operations, design, and management of transportation infrastructure systems, including highway, tolling, bridge, and railroad projects. She brings to her role at PennDOT strong working relationships with transportation authorities and governments across the Pennsylvania region, including

the Pennsylvania Turnpike Commission, Philadelphia International Airport, Delaware River Port Authority, SEPTA, AMTRAK, and the City of Philadelphia.



ASHE 2021 National Conference

May 25-27, 2021

Session 1 - Corner Design For All Users



Historically, intersections have been designed to facilitate easy turning by infrequent design vehicles. This approach has resulted in countless intersections that are much larger than they need to be; intersections where pedestrians and bicyclists confront long crossings that leave them exposed to turning vehicle traffic moving quickly along large corner radii. This presentation makes the case, with case study examples, for a more thoughtful approach to intersection corner design as communities place greater priority on reducing serious injuries and deaths among vulnerable road users

Kristie Di Cocco, PE; Alta Planning + Design, Inc. - Troy, NY

Kristie is an experienced transportation engineer with a vast portfolio. She excels at bringing projects from scoping to construction with her focus being on creating construction documents that reflect the available budget and desires of the community. Her experience includes the design for pedestrian and bicycle accommodations, roadway rehabilitation, and roundabout design. While her projects are varied, her passion for creating spaces for all transportation users has led her to specialize in trail design, Complete Streets, and the public involvement often needed to bring these important projects towards construction.

Nataliya Pekar, EIT; Alta Planning + Design, Inc. - Troy, NY

Nataliya specializes in transportation engineering and has a critical lens for equity and sustainability. Nataliya previously worked for the City of Toronto in their Pedestrian Projects Unit where she supported design, analysis, and policy work on a variety of portfolios such as road safety and accessibility. At the Ministry of Transportation, Nataliya performed contract administration and inspection for design and construction projects where she successfully managed conflict and steered projects towards completion. She combines this passion for transportation infrastructure with her desire to provide a safer user experience for the most vulnerable users.

Session 2 - Central Susquehanna Valley Transportation (CSVT) Northern Section Project

The Central Susquehanna Valley Transportation (CSVT) Project, Northern Section, a 5.3 mile four-lane limited access highway on new alignment in Snyder, Union, and Northumberland Counties, PA, is part of an overall 13-mile project corridor. The project will relieve congestion (including on existing US 15, a four-lane signalized roadway, in Lewisburg and on PA 147, a two-lane free-access roadway, in Northumberland) and improve safety by separating trucks and through traffic from local traffic. Construction of this \$307 million project, completed through 4 separate contracts, began in Fall 2015 and is anticipated to be completed in Fall 2022 (to date, construction has been completed on 3 of the 4 contracts).

Barbara T. Hoehne, PE; STV Incorporated - Harrisburg, PA

Ms. Hoehne is Civil/Highway Senior Project Manager/Engineering Director/Discipline Chief for Transportation and Infrastructure Groups in Pennsylvania and New Jersey. She graduated from University of Delaware with a Bachelor's of Civil Engineering Degree and has over 30 years of



ASHE 2021 National Conference

May 25-27, 2021

TRACK 1 – PLANNING AND DESIGN

civil/highway design and project management experience. She has been with STV for 7 years. The focus of her experience has been on projects for the Pennsylvania Department of Transportation and Pennsylvania Turnpike Commission. Ms. Hoehne was also named WTS Central PA 2021 Woman of the Year and serves as ASHE Altoona Session 1st Vice President.

Session 3 - One Corridor, Two Projects, A Common Vision: A review of the Empire State Trail



The Henry W. Dubois Drive corridor has become a critical connection in the New York Hudson Valley of the 750-mile Empire State Trail. Linking the Wallkill Valley Rail trail to the west and the Hudson Valley Rail Trail to the east, this section of road was the last on-road piece of the Empire State Trail between NYC and Kingston, NY. It has rolling terrain, is heavily vegetated, and yet, experiences large volumes of pedestrians and bicyclists on a roadway that is approximately 22 feet wide. The presentation will provide a brief project history and review design criteria challenges, address roadway deficiencies and the solutions developed to address stakeholder desires while meeting the technical demands of the roadway that reflects the design intent of the world-class Empire State Trail.

Kristie Di Cocco, PE; Alta Planning + Design, Inc - Troy, NY

Kristie is an experienced transportation engineer with a vast portfolio. She excels at bringing projects from scoping to construction with her focus being on creating construction

documents that reflect the available budget and desires of the community. Her experience includes the design for pedestrian and bicycle accommodations, roadway rehabilitation, and roundabout design. While her projects are varied, her passion for creating spaces for all transportation users has led her to specialize in trail design, Complete Streets, and the public involvement often needed to bring these important projects towards construction.

Lindsay Zefting, PE; Alta Planning + Design, Inc - Troy, NY

Lindsay brings both planning and engineering experience to the team. Her areas of expertise include route selection, economic benefits analysis, environmental assessments, ADA compliance and safety measures, and project evaluation. She has employed her skills in a wide variety of projects, from blueway trail planning to greenway design and construction. The integration of engineering and planning experience allows her to consider broader planning visions and innovative concepts while remaining focused on the details for successful implementation.



ASHE 2021 National Conference

May 25-27, 2021

TRACK 1 – PLANNING AND DESIGN

Session 4 - Overcoming Foundation Challenges in Dual Highly Charged Aquifers



The Stark-77 project has a 50 foot tall wall-type abutment supporting mainline I-77 and a ramp in Canton, Ohio was sliding laterally. Site monitoring, research and exploration uncovered dual charged aquifers atop a pre-glacial buried valley. Of the nearly 9,000 LF of friction shafts bid, 10 - 48" diameter drilled shafts constructed for the ramp pier needed to pass through both aquifers to using specialty drilled shaft installations. Unique design, testing and construction sequencing will be covered.

Eric Dues, PE, SE, Gannett Fleming Project Manager - Columbus, OH

Eric Dues leads the Columbus, Ohio bridge group for Gannett Fleming and has been with the company for all of his 17 years of professional work. He is the consultant project manager for the Stark-77 project, holds an Associate's degree in mechanical engineering from Wright State University, a Bachelors degree in civil engineering from the University of Cincinnati. He is routinely involved in bridge and structure projects ranging from railroad to roadway to construction engineering and is a licensed PE or SE in 6 states. Eric is an active member of AREMA Subcommittee 15, Steel Structures, and occasional university research partner and thesis advisor.

Tom Monaco, PE, Gannett Fleming Lead Geotechnical Engineer - Columbus, OH

Tom Monaco leads the Ohio geotechnical group for Gannett Fleming, has been with the company for 13 years of his 23 year career, and is the lead geotechnical engineer for the Stark-77 project. He is a licensed engineer in Ohio and is experienced in the investigation, engineering, and construction of foundations for bridges and buildings.

Laura Beese, PE, Ohio Department of Transportation PM - Columbus, OH

Laura M. Beese, P.E. is currently the ODOT District 4 Design Engineer, which oversees in-house design, consultant management, right-of-way, LPA, and contracts. Laura has over 17 years of professional experience in the transportation industry and is the ODOT Project manager for the Stark-77 Interchange Project, better known as the "Floating Bridge Project", that was awarded in 2019 for \$56 million. Laura is currently the lead ODOT project manager on the SUM-8-1.75 High Level Bridge Project as well as a recent TRAC project, completed last year, which is a brand-new interchange in Mahoning County at I-680 and SR 164. Laura is a Youngstown State University graduate and currently resides in Green, Ohio.



ASHE 2021 National Conference

May 25-27, 2021

TRACK 1 – PLANNING AND DESIGN

Session 5A - Closing a Critical Gap in the Schuylkill River Trail: Using Creative Engineering Solutions to Transform a Highway Bridge Into a Multi-Modal Bridge.

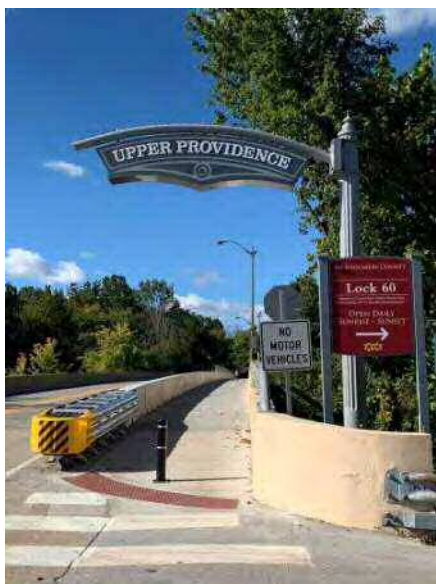

The goal of this project was to close a 1,000' gap in the Schuylkill River Trail (SRT) across the Route 29 Bridge over the Schuylkill River between Phoenixville and Mont Clare, PA. This session will describe the creative engineering/construction solutions used to retrofit the bridge and adjacent roadway/sidewalk areas to create a vital link in this 128 mile regional trail.

Chris Stanford, PE, PMP, PTOE, Michael Baker International - Allentown, PA

Chris is a professional civil engineer, certified project management professional and certified planner with over 25 years of experience designing, planning and managing transportation, park and bicycle/pedestrian projects in eastern Pennsylvania. He has managed a wide variety of projects with a construction value up to \$32 million dollars through the entire planning, design and construction process. He holds a bachelor's degree in civil engineering from Lafayette College and a master's degree in Civil Engineering from Villanova University. Chris also has over 20

years of specialized expertise in parks, shared use path, rails to trails, safe routes to school, greenway planning, design and construction projects. In 2020, Chris was recognized with the Association of Pedestrian Bicycle Professionals-Delaware Valley Chapter's first ever Professional of the Year Award for his tireless effort to advance bicycle/pedestrian infrastructure in the Philadelphia region.

Session 5B – Complete Streets - Redefining Greensboro's Gateway

This session will look at the City of Greensboro's planning efforts to reallocate the right of way along a 1.8-mile stretch of W. Gate City Boulevard to enhance safety for all modes and improve the aesthetic character of an important City corridor. This session will review the W. Gate City Boulevard corridor and discuss issues and trends as they relate to Complete Street planning in similar urban contexts across the country.

Adam Archual; Gannett Fleming, Inc. - Raleigh, NC

Adam is a Senior Environmental Planner in Gannett Fleming's Raleigh Office with a background in cultural resource management and historic preservation. Adam has been working in the transportation industry for 9 years as a cultural resource subject matter expert and as lead environmental planner responsible for NEPA and state-equivalent compliance for surface transportation projects across the southeast US. In his role, Adam is routinely involved in the early planning for transportation projects and in the engagement of the public and stakeholders in the development of transportation projects that serve the needs of all communities.

Carrie Long; Gannett Fleming, Inc. - Philadelphia, PA

Carrie is a Senior Transportation Planner in Gannett Fleming's Advanced Mobility Group and is based in Philadelphia, PA. Carrie works on projects to prepare for the integration of transformative, connected, and automated mobility. Previously, Carrie served as the Director of the Center for Safe Mobility, where she developed new ways of understanding mobility, wayfinding, and safety to inform the policies that shape the design of our streets and transportation systems.



ASHE 2021 National Conference

May 25-27, 2021

TRACK 1 – PLANNING AND DESIGN

Session 6 - Pennsylvania DOT and Pennsylvania Turnpike Commission Executive Panel

Open Discussion with PennDOT District Executives from District 4, 5, and 6, along with the Chief Executive of the Pennsylvania Turnpike.

Richard Roman, PE; District 4 Executive, Pennsylvania Department of Transportation - Dunmore, PA

Rich has served as the District Executive for PennDOT's Engineering District 4 since January 2019 and oversees a 6-County area in northeast PA and is involved in the Design, Construction, Maintenance and Operations of 4,000 miles of roads and 2,100 bridges. Prior to coming to District 4, Rich was PennDOT's Director of the Bureau of Maintenance and Operations for 5 years. Prior to joining the Bureau, Rich worked in Engineering District 8-Harrisburg for 16 years. He served as the ADE for Maintenance, Design Services Engineer, and various civil engineering capacities starting in 1998. Rich is a graduate of Penn State, obtaining a BS in Civil Engineering and a minor in Environmental Engineering; along with a Master of Public Administration Degree.

Christopher Kufro, PE; District 5 Executive, Pennsylvania Department of Transportation - Allentown, PA

Mr. Kufro directs a team of 84 PennDOT employees and 17 consultant project managers responsible for the planning, programming and delivery of transportation improvement projects in Berks, Carbon, Lehigh, Monroe, Northampton and Schuylkill counties. He joined PennDOT in 1997, and has held many positions, including Acting Assistant District Executive for Design, Bridge Squad Supervisor, District Geotechnical Engineer and District Bridge Engineer. Kufro is a graduate of Drexel University with a degree in civil engineering and is licensed as a professional engineer. He resides in Frackville, PA.

Michael Rebert, PE; District 6 Executive, Pennsylvania Department of Transportation - King of Prussia, PA

Mr. Rebert has served as district executive of the state Department of Transportation's Engineering District 5-0 since 2008 and is currently Acting District Executive for PennDOT District 6-0. A 30+ year PennDOT employee and a civil engineer, Rebert grew up in Salisbury Township and graduated from Salisbury High School in Pennsylvania's Lehigh Valley. He previously worked as highway maintenance manager for PennDOT's Chester County office before returning to the Lehigh Valley. He lives in Weisenberg Township with his wife, Debra, and children Megan, and Michael.

Mark Compton; Pennsylvania Turnpike Commission Chief Executive Officer - Harrisburg, PA

Mr. Compton of Manheim, Pa., began serving as chief executive officer of the Pennsylvania Turnpike Commission on Feb. 1, 2013. A professional with more than two decades of public and private-sector experience in transportation, administration, government affairs, and construction, Mark holds a Bachelor of Science degree from Penn State University. He previously served as PennDOT's deputy secretary of administration, overseeing eight bureaus within the agency. Before joining PennDOT, Mark was director of government affairs for American Infrastructure, a heavy civil construction company in Worcester, Pa. Prior to that, he worked in various public and private operations, focusing largely on transportation, construction, and economic development. Mark has been an active participant in the International Bridge, Tunnel and Turnpike Association, or IBTTA. Since 2015, Mark has served on IBTTA's Board of Directors and is currently serving as IBTTA's first vice president and is slated to serve as president in 2021.



ASHE 2021 National Conference

May 25-27, 2021

TRACK 2 - INNOVATION

Session 1 - Leveraging Technology to Optimize Operations

Learn the benefits of a formalized Digital Transformation Strategy, and how to use it to optimize operations. We will show specific examples how technology can be used to improve safety, provide remote site access for walkthroughs and project meetings, and enhance construction progress reviews

Heather Heeter; Borton-Lawson - Bethlehem, PA

Heather Heeter is the Transportation Business Unit Leader for Borton-Lawson Engineering. Heather has 20 years of Transportation experience delivering large, complex project for the Commonwealth. Her extensive background and understanding of the state and federal environmental process, transportation funding and the complete project delivery process have attributed to her successes in the Transportation Industry. Mrs. Heeter is active in ASHE currently serving as the Immediate Past President for the East Penn Section, as well as vice-chair for the Lehigh Valley Chamber's Transportation Committee.

Walt Stout; Precise Visual Technologies - Wilkes-Barre, PA

Walt Stout is the Business Development Leader for Precise Visual Technologies which is the group focused on Digital Transformation and Technology within Borton-Lawson Engineering. Walt has 10+ years of mechanical engineering and technology implementation experience. This experience allows him to identify and implement appropriate technology solutions in order to optimize his client's business. Prior to joining Borton-Lawson Walt served in the United States Navy as a Nuclear Machinist Mate onboard submarines.

Session 2, Track 2 - Lightning Round

Three 15-minute sessions with quick hits in innovation.

1. Lincoln Way Streetscape – Designing the Gateway to Downtown Massillon, Ohio

Lincoln Way Streetscape project - transformed Downtown Massillon, Ohio into an attractive destination with significant infrastructure improvements for the safety of motorists and pedestrians and will be a catalyst for economic growth for years to come. It is located on SR-172 (Lincoln Way) in Downtown Massillon, Ohio and is a busy commercial corridor with high pedestrian traffic and plagued by speeding accidents, resulting in safety concerns for both motorized and non-motorized travelers.

Jeremy Hinte; OHM Advisors

Jeremy is an Ohio Registered Landscape Architect with over 16 years of experience. He has integrated his passion for high quality design with the desire to enhance the environment and local communities, and to create planning and design solutions that positively impact our society. A detail-oriented and creative designer, Jeremy is an adept collaborator who works enthusiastically across disciplines to deliver visionary solutions for clients. With deep experience in streetscape design and reimagination, Jeremy combines a keen sense of what end users desire in placemaking projects with his natural ability to engage with people in order to bring their community's long-term project vision to life.

2. Merging Multiple Survey Data Sets (Aerial, Land, and Hydro)

Merging multiple data sets from different data collection methods including; Hydrographic Multibeam data, Terrestrial LiDAR Surveying, UAS data acquisition, and Conventional methods.



ASHE 2021 National Conference

May 25-27, 2021

TRACK 2 - INNOVATION

Ultimately creating a seamless mesh and one final overall data set. Cases studies to include roadway and bridge/tunnel projects.

Ivan Lineberry, LS; Precision Measurements, Inc - Virginia Beach, VA

Mr. Lineberry is a licensed land surveyor in the Commonwealth of Virginia as well as an FAA licensed drone pilot and 3D Scanning expert. The majority of his experience has been for local, state, and federal government agencies. He serves as the Virginia Beach Office Manager for Precision Measurements, Inc. and oversees the Hydrographic Surveying, UAS, and 3D Scanning Divisions.

3. Stites Tunnel: Replacing the Bridge Inside a Tunnel

This presentation will highlight engineer-contractor-owner collaboration on the alternate design of a unique bridge replacement project inside a railroad tunnel to overcome construction challenges utilizing precast concrete, segmental bridge design and post-tensioning to facilitate site scheduling and ultimately delivering a cost-effective structure with minimal future maintenance.

Quentin D Rissler, PE; Larson Design Group - Lititz, PA

Mr. Rissler has 29 years' experience and has been with Larson Design Group for 12 years, currently as Program Manager for the Bridge Unit in their Lititz, Pennsylvania, focusing on management and project oversight for bundled bridge packages, construction phase engineering and innovative project delivery. Quentin is a registered Professional Engineer in four states.

Session 3 - Accelerated Bridge Construction- Integrating New Technologies in Bridge Construction

ABC has been gaining popularity in the U.S. and boasts the advantages of rapid construction, less traffic disruption, improved quality and durability, improved safety, and fewer environmental impacts. This presentation will introduce ABC to those who may be unfamiliar with this construction method and a practical guide to integrating precast concrete elements in ABC applications. The presentation will outline the current available documents provided by the FHWA and AASHTO to assist with implementation of this methodology

Eric A. Carleton, PE; Director of Codes and Standards, National Precast Concrete Association - Carmel, IN

Eric Carleton is a registered engineer in Indiana and civil engineering graduated from Colorado State University. He worked 10 years for Armco Steel in Minnesota, 27 years as Corporate Engineer for Independent Concrete Pipe Company, and the past 7 years as Director of Codes and Standards for National Precast Concrete Association.

Session 4 - PennDOT Digital Delivery Directive 2025 – A Gateway to the Future of Project Delivery

PennDOT's Digital Delivery initiative is determining a new path forward, so that by 2025, PennDOT construction projects will be bid using 3D technology and no longer be in a traditional construction plan format. The shift to 3D will touch every part of the project delivery process, from design to construction to post-construction activities such as maintenance and asset management. Attendees will learn how this initiative will reduce project costs, improve design and construction efficiency, and



ASHE 2021 National Conference

May 25-27, 2021

TRACK 2 - INNOVATION

reduce project risks. The presenters will provide a status update for the initiative and discuss the roadmap moving forward.

Dan Giles; Roadway Section Manager, HDR - Mechanicsburg, PA

Dan Giles is a graduate of California State University at Fullerton with a Bachelor of Science Degree in Civil Engineering. He is the Roadway Section Manager in HDR's Mechanicsburg, PA office and his nearly 30-year career has almost entirely been devoted to highway, bridge and transit projects for PennDOT and the Pennsylvania Turnpike Commission. Dan is HDR's Agreement Manager for the Digital Delivery Directive 2025 project.

Allen Melley; PennDOT - Harrisburg, PA

Allen Melley graduated from the University of Pittsburgh with a Bachelor of Science Degree in Civil Engineering. He has been with the Department of Transportation for over 20 years. He started his career in District 9-0 progressing through the Design Ranks before relocating to Central office in 2016. Mr. Melley has held the position of Project Development Engineer and Local Project Delivery Unit Leader. He is now on Special assignment Leading PennDOT's Digital Delivery Directive 2025 initiative.

Session 5 - OpenBridge & OpenRoads – 3D Design & Real World FDOT Applications

3D modeling, visualization, and design is the latest trend and disruption in the transportation industry nationwide. State Departments of Transportation, Regulatory Agencies, Cities, and Municipalities are moving towards requiring 3D deliverables in place of traditional 2D plans. WGI's presentation will focus on the real World benefits and challenges of utilizing OpenBridge Modeler on FDOT projects. WGI will discuss our development of 3D tools and processes for Client review of 3D models, develop checking and quality control procedures for 3D models, as well as define the benefits of 3D in terms of permit coordination and cross referencing all design components of a project into one model including bridges, roadway, drainage, etc. This is even more critical due to the uncertainty surrounding COVID-19, as deliverables and digital meeting materials must be highly visual/interactive.

David D. Lutz, PE; WGI - Tampa, FL

David is a structural engineer with 8+ years of experience in bridge, roadway, and toll facilities design with FDOT D1, D7, and Florida's Turnpike Enterprise (FTE). David is an alumni of UCF (BS) and USF (MS). David's bridge experience includes steel box girders, steel plate girders, steel integral straddle bents, steel integral diagrams, prestressed concrete beams, and reinforced concrete flat slabs. He has experience in all aspects of Toll Facility design.

Kali McNeile, PE; WGI - Tampa, FL

Ms. McNeile is a structural engineer with WGI and a graduate of the University of Central Florida (BS + MS). Kali has been with WGI for five years, starting in the roadway division and transferring to the structures division after two years. Kali has been involved with OpenRoads and OpenBridge since the beginning of her career. She has used these programs to help with engineering decisions on active projects and to strengthen project pursuit efforts.



ASHE 2021 National Conference

May 25-27, 2021

TRACK 2 - INNOVATION

Session 6 - 3D Utilities for a Successful and Cost-Effective project

The complexity of utility infrastructure is often overlooked in the construction efforts of highway engineering. The industry as a whole is rapidly evolving as more state DOT's, counties and municipalities are understanding the advantages of utilizing 3D utility data and its important role in visualizing existing underground and overhead utilities and important infrastructure. Recent advances have been made in the collection of 3D utility data by utilizing equipment such as GIS data, Bluetooth enabled utility designation equipment and highly accurate GPS that can be conveyed into 3D modeling software (Bentley OpenRoads, AUTOCAD Civil 3D). Learn how this technological advancement has made significant strides made in identifying utility conflicts earlier on in the project cycle allowing decisions to be made in real time for design changes and helping to mitigate costly utility relocations and schedule delays.

Evan Dailey, PE; KCI Technologies, Inc. - Duluth, GA

Evan currently serves as KCI's lead for utility services including SUE and Utility Coordination in Georgia, where he has worked for the past 3 years. He previously worked as a SUE and Utility Coordination lead in Texas before moving to KCI. Evan's first introduction to SUE was while working in South Dakota, Montana, Utah, Minnesota as a SUE technician and manager. He has worked on various projects including the Texas High Speed Rail from Dallas to Houston, SH 99/Grand Parkway in Houston, US 290 corridor in Houston, I-30 corridor in Little Rock, AR, US 441 corridor project in Georgia. He has been in the SUE industry for 8 years and currently works with GDOT and local municipalities providing SUE and Utility Coordination on transportation projects

Joseph Porter; KCI Technologies, Inc. - Sparks, MD

Joseph is KCI's SUE and UC national QA/QC and Training Manager. He is an Experienced Quality Assurance and Quality Control Manager NASSCO PACP, LACP and MACP Certified and NULCA Accredited Utility Locator. He has a Bachelor of Science (B.S.) focused in Computer Science from State University of New York College at Oswego.

Cyrun McCall; KCI Technologies, Inc. - Sparks, MD

Cyrun is a Senior Engineer for innovation at KCI Technologies. Cyrus brings a unique combination of practical highway design experience, software knowledge, training experience, problem-solving, and project leadership to the KCI team. Over his 22-year career, Cyrus has used his extensive skillset to improve operational efficiency at every level. His expertise includes researching and implementing new CADD tools, creating renderings and models for project visualization, and training design teams.

Shonnell T Gibbs, Georgia DOT SUE Coordinator - Atlanta, GA

Shonnell currently manages the SUE group for GDOT and serves as the State Subsurface Utility Engineer which manages a group of review engineers and oversees Subsurface Utility Engineering activities throughout the state of Georgia. Shonnell has held this position for the past 4 years and prior to this she has served as a review engineer for the SUE group, worked as a designer in Roadway Design and Traffic Operations for GDOT. Shonnell also manages a group of on-call consultants and has played a pivotal role in moving the GDOT utilities office into 3D design. Shonnell is passionate to cultivate awareness and training for the benefit of subsurface utility engineering for GDOT as well as consultants and municipalities in Georgia. Shonnell graduated from Southern Polytechnic State University and also served in the Army for 8 years (74D/SSG).



ASHE 2021 National Conference

May 25-27, 2021

Session 1 - Steel Dowel/Reinforced Concrete Retaining Wall Stabilizing System

A 479.5-foot long retaining wall system consisting of two parallel rows of steel dowels socketed into bedrock and topped with a reinforced concrete cap was constructed to stabilize a roadway that has been afflicted by chronic landslide movement for over the last 50 plus years. The dowel system allowed for most of the construction work to be performed from the roadway/bench elevation without the need for the placement of equipment on the steep, slide-prone downhill slope. Additionally, the concrete cap used to tie the two rows of dowels together not only served to stiffen the dowel system but was also designed to function as a new sidewalk and roadway curb.



Patrick Brown, PE; Earth Inc. - Pittsburgh, PA

Mr. Brown graduated from the University of Pittsburgh with B.S. in Civil Engineering in 1992. Mr. Brown currently serves as Vice President for Earth, Inc., a geotechnical engineering consulting firm located in Pittsburgh, PA - where he has worked for the last 26 years. Earth, Inc. primarily provides geotechnical engineering services for public sector roadway and bridge projects along with relatively large size commercial developments. As Vice President and Senior Geotechnical Engineer for Earth, Inc., Mr. Brown is responsible for both technical and administrative aspects of geotechnical and supplementary civil engineering projects. Mr. Brown is a member of the American Society of Highway Engineers (ASHE) and Association for Bridge Construction & Design (ABCD).

Session 2 - An ABC Success Story: Blackhall Road over Rum Creek



Accelerated Bridge Construction (ABC) methods can drastically improve an outcome for the client and community. BlackHall Road (CR661) over Rum Creek, located south of Atlanta in Henry County, GA, is a two-lane collector that provides access between suburbs and primary arterial and interstate accesses in the region. This project involved the removal and replacement of a structurally deficient bridge carrying CR661 over Rum Creek. The project site is tightly constrained by residential land uses and the 600-acre

Lake Spivey. An earthen dam impounds Lake Spivey with a concrete spillway, immediately upstream of the bridge, forming the headwater of Rum Creek. The existing 108-foot, three-span pile bent supported bridge was replaced with a 195-foot, three-span structure, including a 93-foot long main channel span using innovative ABC methods and materials. The project initially assumed a 9-month road closure and off-site detour. Responding to public input, innovative ABC techniques were implemented that reduced the road closure to just 60 days.

Thomas P. Karis, P.E., Chief Engineer; CHA Consulting, Inc. - Albany, NY

Tom is Senior Vice President & Chief Engineer of infrastructure at CHA Consulting, providing over 35 years of transportation infrastructure design, construction, and management experience. He is a registered PE in 17 states and has been involved with, or directly responsible for, all types of projects ranging from traditional transportation improvements to complex multi-state and international infrastructure initiatives.



ASHE 2021 National Conference

May 25-27, 2021

TRACK 3 - CONSTRUCTION

Session 3 - I-84 "Twin Bridges" Replacement Project



Pennsylvania is undertaking a critical replacement of parallel twin-girder structures located on I-84 over Roaring Brook and the active DL&W Railroad in Lackawanna County, Pennsylvania. The project includes replacement of the two mainline structures with spans up to 330 feet as well as reconfiguration of an adjacent interchange with a fly-over structure. The challenging project site includes an active railroad, Roaring Brook, and steep terrain requiring the construction of several access roads, staging areas, crane pads, and temporary crossings of Roaring Brook for construction access, erection, and removal of the existing bridges. The project also includes the innovative use of an abandoned circa 1883 railroad bridge as a haul road and, after the project is complete, as a critical stream crossing for a recreational trail.

Tim Benner, PE; McTish, Kunkel & Associates - Allentown, PA

Mr. Benner has 30 years of transportation and bridge design experience and is currently a Vice President with McTish, Kunkel & Associates. He holds a Bachelor of Science degree in Civil Engineering from the University of Pittsburgh and is a registered Professional Engineer in Pennsylvania, Ohio and Michigan.

Benjamin Martz, PE; McTish, Kunkel & Associates - Allentown, PA

Mr. Martz served as Lead Structural Engineer and Assistant Project Manager for the I-84 Twin Bridges Project. Mr. Martz holds a Bachelor of Science degree in Civil Engineering from Penn State University and a Master of Engineering in Structural Engineering from Lehigh University. He is a registered Professional Engineer in Pennsylvania with twelve years of structural design experience.

Susan Williams; Pennsylvania Department of Transportation - Dunmore, PA

Ms. Williams served as the PennDOT Project Manager for the I-84 Twin Bridges Project. She has 28 years of transportation design and management experience and is currently a Senior Civil Engineer Supervisor with PennDOT District 4-0 in Dunmore, PA.

Session 4 - Automated Work Zone Speed Enforcement



Automated Work Zone Speed Enforcement has been in use in Pennsylvania for over a year. This session will present background of the program, program operation, and an update on program statistics, trends, and observations.

Ben Snyder - RK&K - Harrisburg, PA

Mr. Snyder is a senior project engineer with more than 10 years of experience. He began his career with RK&K in 2010. He has served as a design and project engineer on numerous design projects and planning studies for various clients, including PennDOT and the Pennsylvania Turnpike Commission. Snyder currently serves as the deputy project manager for the Automated Work Zone Speed Enforcement (AWZSE) program



ASHE 2021 National Conference

May 25-27, 2021

TRACK 3 - CONSTRUCTION

Mahmood Shehata - RK&K - King of Prussia, PA

Mr. Shehata is a transportation manager with RK&K, focusing on traffic engineering and ITS services. Much of his experience has been focused on freeway and arterial congestion mitigation projects, and regionally has been at the forefront of these types of solutions for many years. Mr. Shehata is also serving as the Program Administrator for the statewide Automated Work Zone Speed Enforcement Program, a joint PennDOT / PTC / Pennsylvania State Police effort. He is the current President of the Institute of Transportation Engineers, Mid-Atlantic Section (MASITE), a member of the Leadership ITE Class of 2020, and a member of Pennsylvania's Statewide Transportation Innovation Council (STIC).

Session 5A - You Want Me to Build What?

This presentation explains some of the challenges that occur during construction and how they can be avoided with proper planning. It is vital to a projects design to understand the full picture of what is needed and the process of how building and construction occurs. Constructability reviews by subject matter experts during early phases of design can help mitigate delays and change orders. The importance of procurement and specifics in developing bid documents are also crucial. It is essential that all parties have a full, complete picture of what is to be built to obtain appropriate pricing with qualified construction contractors. Included as part of the discussion is how design and construction should have synergy rather than be at odds with one another. Additional dialogue to be held about how to increase efficiency and effectiveness throughout the full project life cycle to get the best value for clients. Best practices, common pitfalls, and lessons learned will also be explained to assist in fully executing successful projects.

Tamae Partain; Arcadis U.S., Inc - Atlanta, GA

Tamae Partain is the CEI Group Lead for Arcadis serving out of their Atlanta, GA office. She a seasoned professional with over 25 years of experience in all aspects of civil engineering. Her experience is in program management, construction management, business development, operations, strategic planning, management consulting, organization performance, legislative assistance, innovation & technology research and implementation, contract administration, finances, logistics, acquisitions, project planning, general implementation, talent acquisition, and staff development. She has experience in a vast amount of infrastructure projects including building construction, water treatment plants, dams, reservoirs, landfills, railroad, materials, parks, roadways, bridges, pedestrian enhancements, traffic, as well as ATMS / ITS Fiber. Her primary focus is with municipal clients and civil / heavy highway infrastructure. She sets up and takes programs and projects through concept, design, environmental, land acquisition, utility coordination, funding / finances, permitting, stakeholder coordination, public relations, contract administration, bidding, procurement of goods and services, scheduling, construction, submittals, testing, QA/QC, and audits until completion. She is Vice-President of the NAWIC Atlanta Chapter as well as a Board Director for the PMI Atlanta Chapter. She is also active with ACEC, WTS, Council for Quality Growth, various City and County organizations.



ASHE 2021 National Conference

May 25-27, 2021

TRACK 3 - CONSTRUCTION

Session 5B - A Modern Truss for the 21st Century - The Pond Eddy Bridge Replacement Project



The historic Pond Eddy Bridge spanning the Delaware River between Pike County, Pennsylvania and Sullivan County, New York, was replaced in 2018 with a two-span Pratt truss structure constructed immediately upstream of the original, pin-connected, Pennsylvania (Petit) thru-truss bridge built in 1905. Unique site conditions, including restricted construction access points, archaeological concerns, T&E species, and the need maintain recreational boating traffic at all times required complex construction staging, significant coordination with environmental and government agencies, and in-depth community involvement through a Design Advisory Committee (DAC) of local stakeholders.

Gregory Soule, PE; SAI Consulting Engineers - Lemoyne, PA

Gregory Soule, PE is the Office Manager and a Senior Project Manager at SAI Consulting Engineers, Inc. in their Lemoyne, PA office. He has over 23 years of experience in the transportation industry following his graduation from Penn State University in 1997. Greg has extensive experience as a highway engineer and project manager on Pennsylvania Turnpike Commission and PennDOT agreements. He also oversees business development for SAI in central and eastern Pennsylvania. Greg is member of ASHE Clearfield, ASHE Williamsport, and ASHE North East Penn, and he currently serves on the Board of Directors for ASHE Harrisburg.

Session 6 - Urban Design-Build

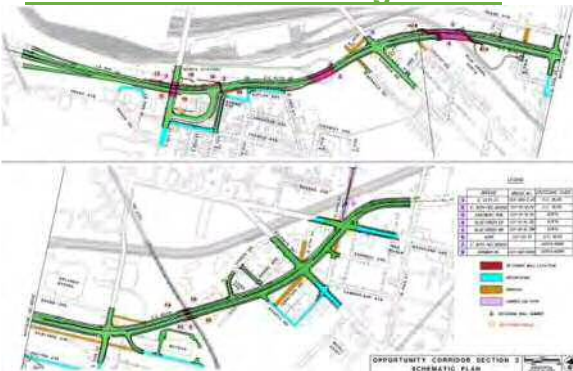

The importance of a good team. It is essential to maintain coordination and communication. Working thru unforeseen challenges.

Sean Milroy P.E., PMP, DBIA; Michael Baker Intl - Cleveland, OH

Sean Milroy is a Project Manager and Civil Engineer for Michael Baker International in Cleveland. His twenty five years of experience include projects ranging from high-profile Interstate improvements to local road bridge replacements, as well as several years of design build experience. Sean is proud to be a United States Air Force Veteran, City Councilman, and he currently volunteers in multiple local civic and school organizations. Sean lives in Highland Heights.



ASHE 2021 National Conference

May 25-27, 2021

Installation of Officers & Awards ceremony – Thursday, May 27, 12:00 pm

- Welcome - *Todd Rousenberger, Conference Co-chair*
- Installation of Officers and Directors - *Mike Hurtt, Immediate Past President*
- Presentation of Section Awards - *Tom Morisi, National Secretary*
 - Gene Smith Award - Bluegrass Section
 - George Hart Award - Tampa Bay Section
 - Terence Conner Award - Potomac Section
 - Robert Yeager Award - Chesapeake Section
- Presentation of honorary awards - *Tim Matthews, National President*
 - Young Member of the Year Award - Danielle DeMeza, NE Florida Section, Southeast Region
 - Lifetime Achievement Award - David Greenwood, Chesapeake Section, Mid-Atlantic Region
 - President's Award - To be announced
 - Robert Pearson, Person of the Year Award - Richard Cochrane East Penn Section, Northeast Region
- Projects of the Year - *Joseph Rikk*
 - Projects under \$20,000,000 - SR 19 Reconstruction & Shaler St. Bridge Replacement
submitted by the Pittsburgh Section, North East Region

 - Projects over \$20,000,000 Jones Branch Connector, Fairfax County, VA
submitted by the Potomac Section, Mid-Atlantic Region
- Recognition of conference committee - *Richard Cochrane*
- Final remarks - *Richard Cochrane*
- 2022 Conference - *2022 Conference Committee*



ASHE 2021 National Conference

May 25-27, 2021

Awards

Robert E. Pearson/Person of the Year Award Winner



The Pearson Award, ASHE's most prestigious award, is given to an individual who has made notable and significant contributions to the transportation industry. The contributions should have a statewide or broader impact and involve paid and personal time and efforts, and participation in transportation-related societies or organizations.

The recipient of the 2021 Pearson Person of the Year Award is **Richard Cochrane** (East Penn Section, Northeast Region).

Dick Cochrane has made numerous contributions to the highway industry throughout his 36-year career working in research, planning, and construction administration for the Pennsylvania Department of Transportation. Dick also served on the PennDOT District 4 leadership team. After retiring from PennDOT, Dick managed major highway corridor projects working for the consulting firm of McTish, Kunkel & Associates. Dick is a graduate of Penn State, has a bachelor's degree in civil engineering, and a master's degree in Public Administration.

Dick has been an active member of ASHE since 1978. During his ASHE tenure, Dick has served as Section President, Northeast Region Secretary, National Director, and National President (2018-2019). Dick volunteered to lead the Northeast Region's formation and helped create the operating procedures and bylaws. Dick is currently the 2021 (and 2025) National Conference Co-Chair and the ASHE National Webmaster. His personal commitment to the entire ASHE organization has been enormous.

Dick has been a transportation leader in the organization and advocate for transportation alternatives through his involvement in bicycle and pedestrian trails in northeastern Pennsylvania. Dick serves in leadership roles as the:

- Anthracite Scenic Trails Association Treasurer
- Anthracite Bicycle Coalition Treasurer
- Northeast Pennsylvania Trails Symposium Organizer

Dick also serves the First Presbyterian Church of Clark Summit as an Elder and Choir Director. He and his wife Marie have two sons and four grandsons. Along with Marie, they ride their tandem bicycle wherever they can.

Congratulations to Dick Cochrane as recipient of this great ASHE honor!

Russell Horn Biography & Grant Info

Russell E. Horn, Sr., P.E, was a 1933 graduate of the Pennsylvania State University, with a degree in Civil Engineering. He was a Registered Professional Engineer in Pennsylvania and more than (20) other states. He was a Charter Member of the Harrisburg Section, which he joined in 1958 and became a Life Member. Mr. Horn passed away in December 2013 at the age of 101. Russell E. Horn, Sr., P.E., was the Founding Father



ASHE 2021 National Conference

May 25-27, 2021

of the York, Pennsylvania Engineering Firm, Buchart Horn, Incorporated. He was a Charter Member of the first formed Section of ASHE in Harrisburg, PA and is the 17th name to appear on the Original Charter.

\$1,000 GRANT

A \$1,000 Grant is given to the favorite charity of the recipient of the Robert E. Pearson/Person of the Year Award. The Russell Horn Grant will continue to be funded through the Russell and Eleanor Horn Foundation. We are grateful to Mr. Horn and to this foundation for the continued support of this grant.

Robert E. Pearson/Person of the Year Award Honorees

2021	Richard Cochrane	2006	Raymond Pethtel	1988	Denver Collins, Jr.
2020	Dr. Eugene Conti Jr.	2005	Senator J. Barry Stout	1987	Kenneth Larson, Jr.
2019	Paul Degges P.E.	2004	Thomas F. Barry, Jr., P.E.	1986	Warren Smith
2018	Christopher Runyan	2003	Michael H. Dufalla	1985	David Sims
2017	Robert Collyer, P.E.	2002	Thomas Ridge	1984	Drew Lewis
2016	Barry Schoch, P.E.	2001	Wayne Shackelford	1983	John Graham, Jr., P.E.
2015	Michael M. Ryan, P.E.	2000	Roland Nesslinger	1982	Thomas Larson
2014	DeLane Meier, P.E.	1998	Ben G. Watts	1981	Robert Hirschman
2013	Richard E. Stees, PLS	1997	Marshall W. Moore	1980	W. Guy Gunn
2012	Frank J. Kempf, Jr., P.E.	1996	Kenneth Afferton	1979	Rep. Doug Walgren
2011	Marvin G. Murphy	1995	Ronald Zook	1978	Wilmer Eidermiller
2010	James Jurgensen, Sr.	1993	Ellis Vieser	1977	William C. M. Butler, Jr.
2009	Thomas D. Moreland, P.E.	1992	Francis Franscois	1976	Rep. "Bud" Shuster
2008	Russell E. Horn, Sr., P.E.	1991	John Rurter	1975	Donald Stabler
2007	Jack Lettiere	1990	Wayne Kauble	1974	Jacob Kassab
		1989	B. J. Smith		



ASHE 2021 National Conference

May 25-27, 2021

Lifetime Achievement

This award is for ASHE Members only and was established to recognize an ASHE member who has supported the organization throughout their career.

The 2021 Lifetime Achievement is awarded to **David Greenwood** (Chesapeake Section, Mid-Atlantic Region).



Dave has been a member of ASHE since the late 1970's, beginning his ASHE tenure in the **Delaware Valley Section**. Dave was a charter member of the **Chesapeake Section** in 1988. Dave has served twice on the ASHE National Board, first in the 1990's and later in the 2010's. Dave was ASHE National's 38th President (1996-1997). During his time on the National Board, Dave served as chair of the Ethics Committee, New Sections Committee, and Constitution and Bylaws Committee (current), and as a member of the Nominations Committee and the Operations and Oversight Committee. Dave was also the co-chair for the 2015 National Conference in Baltimore. Dave is in his fifth decade of active service to the ASHE organization, and still going strong.

Dave is a graduate from Bucknell and received two degrees: Bachelor of Science in Civil Engineering and a Bachelor of Arts in Music. Dave continued his education and earned a Master of Business Administration from Temple University. Dave has worked for several A/E firms and currently is with CDM Smith. Dave is currently serving as the Project

Manager for the \$1.1B I-95 ETL Northbound Extension in Baltimore and Harford Counties.

Dave is a huge railroad buff, and currently serves as the Clerk of the Board of Directors for the Maryland and Pennsylvania Railroad Historical Society. He is also a member and resident agent for the Senior Science Society of Hartford County, Maryland. Dave has been married to his wife Gayle for 48 years, has 3 children and 3 grandchildren.

Congratulations on this well-deserved honor, Dave!

Lifetime Achievement Recipients

This prestigious award is for ASHE Members only and was established to recognize an ASHE member who has supported the organization throughout their career.

2021	David Greenwood	Chesapeake
2020	Charlie Flowe, PE	Carolina Triangle
2019	Calvin Leggett, PE	Carolina Triangle
2018	Gerald "Jerry" Pitzer, PE	Pittsburgh
2017	David W. Jones, P.E	Central Ohio
2016	Jeffrey Sievers	Central Florida
2015	Sandra K. Ivory	Altoona
2014	Rodney Pello, P.E	North Central New Jersey
2013	Richard S. Prentice	Delaware Valley
2012	Tamara "Tammy" A. Johnson	Pittsburgh



ASHE 2021 National Conference

May 25-27, 2021

Young Member of the Year Award

This award recognizes a young member (under age 35) that has contributed significantly to ASHE and/or the highway industry.



This award has been established to recognize young ASHE members who have made outstanding contributions to the highway / transportation industry and their communities during the early years of their careers.

The 2021 ASHE Young Member of the Year is awarded to **Danielle DeMeza** (NE Florida Section, Southeast Region).

Danielle has contributed extensively to the local Jacksonville, FL, professional community and brings energy and enthusiasm to the continuing youth movement in our industry. Danielle has served the **NE Florida Section** (Jacksonville) as Director of Community Outreach, member of the Charity Golf Committee, and is the Section's Regional Director. She has maintained a high level of commitment to ASHE while working full-time, serving other professional organizations and charities, and obtaining a master's degree.

Danielle is a licensed Geotechnical Engineer and currently holds a Project Administrator position with VIA Consulting Services, Inc. in their Construction Engineering Inspection group. Danielle is a graduate of Florida State University, has a bachelor's degree in civil engineering and a Master of Science in Civil Engineering from the University of Florida.

Outside of ASHE, Danielle is the current Jacksonville Branch President of ASCE, serves as a committee member for the Northeast Florida Chapter of the Florida Engineering Society (FES), participates with the Northeast Florida Engineer's Week, and is a member of the American Foundation for Suicide Prevention – Northeast Florida Chapter.

Congratulations Danielle!

Young Member of the Year Award Recipients

2021	Danielle DeMeza	NE Florida
2020	Denila Deliallisi, PE	Chesapeake
2019	Laura Campos	Central Florida
2018	Amanda Lafleur	Chesapeake
2017	Whitney Stevens	Tampa Bay
2016	John Caperilla	Delaware Valley
2015	Timothy Belcher	Potomac
2014	Vanessa Fritsch	Triko Valley
2013	Patrick J. Herl	Central Ohio
2012	Kathryn E. Power	Pittsburgh
2011	Yung Koprowski	Phoenix Sonoran
2010	Barbara Jordan, P.E	Central Ohio
2009	Jill Kaempf	Georgia



ASHE 2021 National Conference

May 25-27, 2021

ASHE Member of the Year Award

This award recognizes someone that has contributed greatly to the growth and development of ASHE during the previous year.

2021	None Selected	
2020	Richard Grubb	Southern New Jersey
2019	Donna McQuade	Northeast Florida
2018	James Shea, P.E.	Lake Erie
2017	Dawn Fortuna, AICP	Phoenix Sonoran
2016	No Submissions	
2015	Caroline F. Duffy, P.E.	Triko Valley
2014	Tim Matthews, P.E.	Georgia
2013	Perry Schweiss, P.E.	Southwest Penn
2012	Charles T. Liggett	Central NY
2011	John A. Derr, P.E.	Phoenix Sonoran
2010	Samir Mody, P.E.	Southern New Jersey
2009	Jacklyn VanderPol	Central Florida

National President's Award

This award recognizes a member that has contributed greatly to the ASHE organization during the President's term. The National President has full discretion as to whom an award will be presented. **This award is announced at the annual conference.**

2020	Amanda Schumacher	2000	Pasquale A. Dougherty, P.E.
2019	Lynelle Flowe	1999	Roland Nesslinger, P.E.
2018	Tammy L. Farrell	1998	Lisle E. Williams, P.E.
2017	Charles L. Flowe, P.E.	1997	Albert W. Kozel, Jr., P.E.
2016	David Greenwood, P.E.	1995	Michael Martin, P.E.
2015	Jennifer Yoder	1994	James W. Charles, P.E.
2014	Nikki G. Parris, P.E.	1993	Roland Nesslinger, P.E.
2013	Jacob A. Morisi	1992	Robert E. Yeager, R.S.
2012	Gerald J. Pitzer, P.E.	1990	Raymond Petrucci, P.E.
2011	Shirley Stuttler	1989	R. Paul McConnell
2010	Thomas Morisi & Craig Rock	1987	Stephen B. Lester, P.E.
2009	Calvin Leggett, P.E.	1986	John DeRenzo
2008	Sandra K. Ivory	1985	Matthew J. McTish, P.E.
2007	David Jones, P.E. & Andrew Stasek	1984	Terence D. Conner, P.E.
2006	No Award Given	1983	Delaware Valley Section
2005	David Jones, P.E. & Michael Hershey, P.E.	1982	Robert Yeager, R.S.
2004	Al Algazi, P.E. & Richard Prentice	1981	Charles Luff
2003	Diane Conner & Mariann Yeager	1979	Robert Stallknecht, P.E.
2002	Evelyn Curtis	1978	Gene G. Smith, P.E.
2001	No Award Given	1977	Robert M. Sherr, P.E.



ASHE 2021 National Conference

May 25-27, 2021

Gene G. Smith Award

In 1989, the “Gene G. Smith Award” was established and is presented to the Section with the largest number of new members within the current fiscal year.

The 2021 Gene G. Smith Award is presented to the Bluegrass Section. This award is given annually to the Section with the largest numeric increase in membership. The Bluegrass Section membership has increased by 23 members from April 2020 to April 2021.

Gene G. Smith, P.E., Biography

Mr. Gene G. Smith was a Professional Engineer and a Professional Land Surveyor in the Commonwealth of Pennsylvania. Gene became directly involved with the transportation industry in 1963 when he began his career with the PA Department of Highways in Franklin, PA.

Mr. Smith joined the Franklin Section in 1964, serving in various capacities on the local Board of Directors and was elected Section President in 1975. He also served on the National Board of Directors and in 1980 was elected National President.

During his term on the National Board, Gene served as Chair of the New Sections Committee. After much consideration, the National Board created their first slide presentation to promote ASHE. New ASHE Sections were chartered; two in Ohio and two in West Virginia. Gene was awarded the President’s Award in 1978 for the establishment of these Sections. With regard to respect from his peers, he was named the fourth ASHE Honorary Member in 2001, which clearly exemplifies the high esteem and admiration shown by the ASHE members he was associated with.

Gene G. Smith Award Winners

2021	Bluegrass	23	2002	Central Florida	89
2020	Georgia	102	2001	Southern New Jersey	79
2019	Georgia	190	2000	Harrisburg	76
2018	Chesapeake	47	1999	Pittsburgh	79
2017	New York Metro	75	1998	Delaware Valley	48
2016	Middle Tennessee	80	1997	Carolina Triangle	31
2015	Clearfield	2	1996	Central Florida	57
2014	Potomac	50	1995	Central Florida	54
2013	Georgia	42	1994	First State	38
2012	Middle Tennessee	30	1993	North Central New Jersey	7
2011	Delaware Valley	30	1992	Pittsburgh	95
2010	Mid-Allegheny	39	1991	Chesapeake	40
2009	Southwest Penn	29	1990	Chesapeake	36
2008	Georgia	67	1989	Chesapeake	34
2007	Georgia	120			
2006	Georgia	80			
2005	Northeast Florida	62			
2004	Northeast Florida	37			
2003	Potomac	62			



ASHE 2021 National Conference

May 25-27, 2021

George Hart Award

The George K. Hart Award, in memory of a former National Treasurer, was started in 1975 to honor the Section which showed the greatest percentage of membership increase within the current fiscal year. The first "George Hart Award" was presented to the Pittsburgh Section in 1976.

The 2021 George K. Hart Award is presented to the Tampa Bay Section. The Tampa Bay Section had a membership increase of 45.3% from April 2020 to April 2021.

George K. Hart Biography

Became a National Director in 1965 and assumed the duties as National Treasurer in 1967. Mr. Hart passed away on October 2, 1975. Before becoming active in the National Society, Hart was very active in the Williamsport Section from its inception.

George Hart Award Winners

2021	Tampa Bay	1998	North Central New Jersey
2020	North Central West Virginia	1997	Potomac
2019	Houston	1995	Tampa Bay
2018	Long Island	1995	Potomac
2017	New York Metro	1994	First State
2016	Middle Tennessee	1993	North Central New Jersey
2015	Clearfield	1992	Potomac
2014	Potomac	1991	Potomac
2013	East Penn	1990	Triko Valley
2012	Middle Tennessee	1989	Mid-Allegheny
2011	Phoenix Sonoran	1988	Mid-Allegheny
2010	Carolina Piedmont	1987	North Central West Virginia
2009	Chesapeake	1986	Altoona
2008	Carolina Piedmont	1985	Central Ohio
2007	Middle Tennessee	1984	Cuyahoga Valley
2006	New York Metro	1983	Ohio Valley
2005	Northeast Florida	1982	Altoona
2004	Carolina Piedmont	1981	North Central West Virginia
2003	Potomac	1980	Charleston
2002	Northeast Florida	1979	Cuyahoga Valley
2001	Old Dominion	1978	Western Reserve
2000	North Central West Virginia	1977	Southwest Penn
1999	Georgia	1976	Pittsburgh



ASHE 2021 National Conference

May 25-27, 2021

Terence D. Conner Award

This award was created in 2007 in recognition of Terence Conner's long service as the National Secretary of ASHE and his work in renewing members for all Sections. The National Board of Directors created this award recognizing that it is just as important to reward those Sections that work hard to keep their existing members, as it is to reward those that work at recruiting new members. In case of a tie for this award, the number of new members added is used as the tiebreaker; however, the Sections that win the Hart or Smith Awards will not be eligible to win this award in a tiebreaker (they are, however, eligible to win the award outright).

The 2021 Terence D. Conner Award is presented to the Potomac Section. The award is given annually to the Section with the best record of membership retention. The Potomac Section membership has increased by 13 members with no dropped members from April 2020 to April 2021.

Terence D. Conner, P.E., PLS, Biography

As a result of his dedicated service to the ASHE Society, the Executive Committee of the National Board, in July 2007, awarded him by naming him one of our Honorary Past Presidents. Terry earned his B.S. in Civil Engineering from Pennsylvania State University in 1961. He began his engineering career in the public sector by gaining employment with the Pennsylvania Department of Transportation. Terry is a Professional Engineer and Professional Land Surveyor in the state of Pennsylvania. He worked more than (30) years in PennDOT at various levels of design and management before retiring from the State.

Terry then moved to the private sector and began working for McTish, Kunkel & Associates, Incorporated in Rostraver, Pennsylvania. He served as their Vice President for western Pennsylvania for (15) years until he retired in May 2005. He is also a member of ASCE, PSPE and NSPE. Much of the Society's continuity of purpose and steady growth are a tribute to his efforts.

Terence D. Conner Award Winners

2021	Potomac
2020	North East Penn
2019	Derby City
2018	Long Island
2017	Potomac
2016	Blue Ridge
2015	Lake Erie
2014	Mid-Allegheny
2013	East Penn
2012	Greater Hampton Roads
2011	New York Metro
2010	Gold Coast
2009	North East Penn
2008	Central Florida



ASHE 2021 National Conference

May 25-27, 2021

Robert E. Yeager Award

The National Board of Directors created this award in 2007 in recognition of Bob's long service as the National Treasurer of ASHE. One distinctive character of ASHE is that all members are treated equally, no matter how he or she contributes to the highway industry. This fact is often what attracts a potential member to the organization so maintaining a balanced and diverse membership should also help boost membership and is, therefore, worthy of recognition. The Section with the best balance of employment types among the new members joining during the past year will receive this award. In the unlikely event of a tie, the larger Section will receive the award.

The 2021 Robert E. Yeager Award is presented to the Chesapeake Section. ASHE's goal of representing everyone involved in the highway industry without prejudice to education or professional licensing is best supported by a broad spectrum of employment categories. Among its new members for April 2020 to April 2021 Chesapeake Section had the best cross section of employment categories.

Robert E. Yeager, P.L.S. Biography

National Treasurer 1975-2008 Bob is a member of the Altoona Section in Region 4. Joining ASHE in 1963, he was a Board Member and President of the Altoona Section. He then served on the National Board and became National President in 1974. He served as National Treasurer from 1975 till 2008. With several years of dedicated service to the ASHE Organization, the National Board granted him an Honorary Membership on April 17, 1998. Bob earned his B.S. in Civil Engineering from Pennsylvania State University in 1959. He later continued his education at Cornell University in Construction Engineering. Bob began his career as a field engineer with the Harrison Construction Company and then with the S. J. Groves Construction Company. Over the next (23) years, he continued to refine his construction skills with Vipond & Vipond, Incorporated, earning promotions from Supervisor to Project Manager, to Vice President of Construction. He then started work with the I A Construction Company where he worked for ten years as their District Manager. From 1995 to 1997 Bob was the owner of R. E. Yeager Consulting, Incorporated. He retired in 1997 after working more than (38) years in the construction industry. Bob has an E.I.T and is a Professional Land Surveyor in Pennsylvania.

Robert E. Yeager Award Winners

2021	Chesapeake
2020	Carolina Piedmont
2019	Triko Valley
2018	First State
2017	Blue Ridge
2016	Blue Ridge
2015	Cuyahoga Valley
2014	Clearfield
2013	Williamsport
2012	Franklin
2011	Williamsport
2010	Franklin
2009	Williamsport
2008	Franklin



ASHE 2021 National Conference

May 25-27, 2021

Under \$20M Project of the Year

SR 19 RECONSTRUCTION & SHALER STREET BRIDGE REPLACEMENT



OWNER: Pennsylvania Department of Transportation
ENGINEER: H.W. Lochner, Inc.
CONTRACTOR: Swank Construction Company, LLC

State Route (SR) 19 is a high-volume, north-south expressway that bisects southern Pittsburgh, carrying 28,000 vehicles daily. The primary route between the North Shore and I-376 to the Pittsburgh International Airport, the corridor serves as the hazardous material bypass for the Fort Pitt Tunnel and provides essential access to Heinz Field, home of the Pittsburgh Steelers. Completing the corridor reconstruction also included replacing Shaler Street Bridge, which crosses over SR 19. The bridge replacement provided an ideal opportunity for the Pennsylvania Department of Transportation to demonstrate the benefit of self-propelled modular transporters (SPMTs), a new accelerated bridge construction (ABC) technology for the Department. Lochner was hired to lead the design, drawing from the firm's national ABC experience for the bridge replacement. The project had numerous non-standard items with no cost history and the engineer's estimate needed to account for the risks associated with using SPMTs for the first time on a State project. Swank Construction Company, LLC was the low bidder on the project coming in at \$14.55million, 17% below the engineer's estimate. Given the complexity of the project, there were minimal change orders resulting in a final construction cost of \$15 million.



ASHE 2021 National Conference

May 25-27, 2021

Over \$20M Project of the Year

JONES BRANCH CONNECTOR

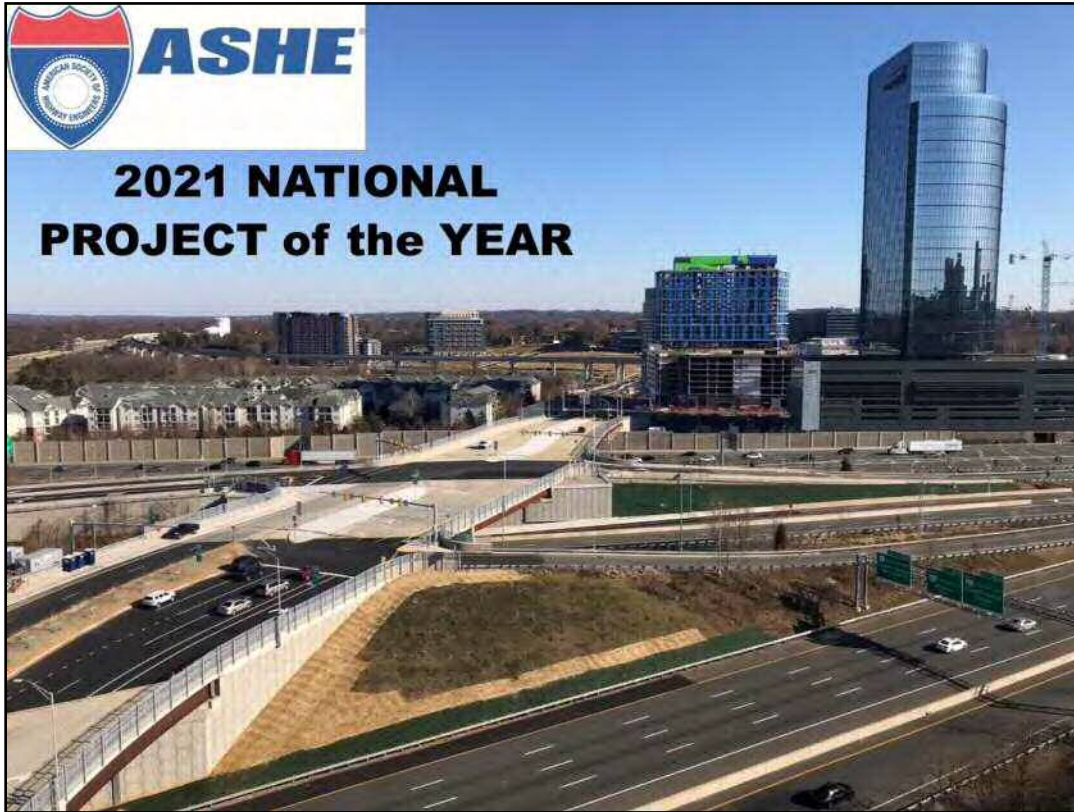

OWNER: Fairfax County Department of Transportation
ENGINEER: Johnson, Mirmiran & Thompson, Inc.
CONTRACTOR: Archer Western

The Jones Branch Connector project was an important achievement in the redevelopment of Fairfax County's Tysons area; literally bridging to connect the two sections of Tysons divided by the Capital Beltway. It marked a milestone in a complex and collaborative effort to improve the transportation network and support a rapidly growing Tysons, while also providing much needed connectivity and additional multi-modal access for all types of commuters—in the present and the future. The purpose of the project was to move more people safely and effectively, but the project also successfully accomplished several other key goals, which will continue to have a positive impact for generations to come. Virginia Department of Transportation District Construction Engineer Bill Cutler called this extensive project a “once-in-a-generation transportation improvement.” With on-road bike lanes, eight-foot-wide sidewalks, connectivity to the Capital Beltway Express Lanes, and even a layout for a future transit in the median, this project was designed for efficiency. The project included widening bridges over the I-495 Outer loop (southbound) and southbound 495 Express Lane as well as designing a new spanning the I-495 Inner loop (northbound) and northbound 495 Express Lanes. Workers installed tall MSE (retaining) walls to the support bridge approaches and other segments of the roadway. This project was a collaborative effort, requiring JMT to work with Fairfax County, VDOT and Archer Western who served as the general contractor. The final cost of the project was approximately \$10 million dollars less than estimated and scope changes during construction further resulted in cost reductions throughout.



ASHE 2021 National Conference

May 25-27, 2021

ASHE National Information

National President - **Tim W. Matthews, P.E.**



Mr. Matthews is a registered professional engineer and has nineteen (19) years of experience in the highway industry including Roadway Engineering and Program/Project Management. Mr. Matthews began his career at the Georgia Department of Transportation in 2002 and has worked as a Program/Project Manager, Senior Design Build engineer, in the office of Roadway Design, Program Delivery, TIA, and Innovative Delivery.

Tim is a graduate of the University of North Carolina at Charlotte with a Bachelor's Degree in Civil Engineering. Tim currently serves as the Major Mobility Investment Program Manager for the Georgia Department of Transportation (GDOT). He is responsible for coordination; management and delivery of the \$11 Billion Major Mobility Investment Program (MMIP) for GDOT.

In addition, Tim has served in Higher Education as an Adjunct Professor and in the private sector for Transportation. Prior to earning his Civil Engineering degree, Tim served in the United States Navy aboard the USS California (CGN 36) near Seattle, Washington.

Tim lives in Atlanta GA with his wife Karyn, and their two boys Aidan and Alex. He enjoys running, hiking, traveling and going to Braves Games.

2021-2022 National Board

Officers

National President Tim Matthews, Southeast Region, Georgia Section
1st Vice President Leigh Lilla, Southeast Region-Tampa Bay Section
2nd Vice President Stan Harris, Great Lakes Region, Triko Valley Section
Secretary Thomas Morisi, Northeast Region, Altoona Section
Treasurer Frank O'Hare, Great Lakes Region, Central Ohio Section
Immediate Past President Michael Hurtt, Northeast Region, Albany Section

Directors

3-year Directors

Michael Bywaletz - Mid-Atlantic Region, Carolina Piedmont Section
Nikole Cao - Southwest Region, Houston Section
Scott Jordan - Southeast Region, Georgia Section
Robert G. Prophet - Northeast Region, Delaware Valley Section

2-year Directors

Frank Bronzo - Great Lakes Region, Cuyahoga Valley Section
Donato Di Zuzio - Northeast Region, North Central New Jersey Section
Jason Hewatt - Southeast Region, Georgia Section

1-year Directors

Roger Carriker - Mid-Atlantic Region, Chesapeake Section
Kathryn Fink - Northeast Region, Pittsburgh Section
Jim Shea - Great Lakes Region, Lake Erie Section



ASHE 2021 National Conference

May 25-27, 2021

ASHE Past National Presidents

2020-19	Tim Matthews, PE	Georgia Section	1988-89	Michael J. Suich	Franklin
2019-18	Michael Hurtt, P.E.	Albany Section	1987-88	Ronald E. Springman, PE	Williamsport
2018-19	Richard Cochrane P.E.	North East Penn	1986-87	G. Michael Tiani	Pittsburgh
2017-18	Greg Dutton, PE	Central Florida	1985-86	William H. Allen, P.E.*	Delaware Valley
		Middle			Cuyahoga
2016-17	Larry Ridlen, P.E	Tennessee	1984-85	Charles E. Luff *	Valley
2015-16	Robert Hochevar, P.E.	Cuyahoga Valley	1983-84	Warren A. Miller *	Altoona
2014-15	Samir Mody, P.E.	S. NJ/NY Metro	1982-83	J. Dixon Earley, P.E.	Harrisburg
2013-14	Thomas S. Morisi	Altoona	1981-82	Charles Sincavage, P.E. Gene G. Smith, P.E.,	East Penn
			1980-81	R.S. *	Franklin
2012-13	Frank O'Hare, P.E./P.S.	Central Ohio	1979-80	George J. Parrs, P.E.	North East Penn
2011-12	Calvin Leggett, P.E.	Carolina Triangle	1978-79	Joseph C. Martinelli	Southwest Penn
2010-11	John L. Hetrick, P.E	Mid-Allegheny	1977-78	Harold C. Poulson, PE*	Harrisburg
2009-10	Kevin E. Duris, P.E.	Pittsburgh			
		Greater			
2008-09	Richard L. Clifton, P.E	Hampton Roads	1976-77	John DeRoss *	Pittsburgh
2007-08	Perry M. Schweiss, P.E.	Southwest Penn	1975-76	Atwood Welker, Jr., PE	Williamsport
2006-07	Richard S. Prentice	Delaware Valley	1974-75	Robert E. Yeager, R.S.	Altoona
2005-06	Ronald Purvis, P.E. *	Potomac	1973-74	James Weaver, Sr. *	Pittsburgh
2004-05	Rodney R. Pello, P.E.	North Central NJ	1972-73	Donald Rimmer *	Harrisburg
2003-04	David W. Jones, P.E.	Central Ohio	1971-72	John Leapson, Jr., P.E.	Delaware Valley
2002-03	Sandra Ivory	Altoona	1970-71	Robert Martzall, P.E.*	Harrisburg
2001-02	Cooper E. Curtis *	Cental Florida	1969-70	Robert Kepner, P.E. *	Clearfield
2000-01	Domenic M. Piccolomini, PLS	Southwest Penn	1968-69	C. J. Wachter, Jr. *	East Penn
1999-00	Charles L. Flowe, P.E.	Carolina Triangle	1967-68	James R. Barnicle, PE*	Franklin
1998-99	James W. Charles, P.E.*	Southern NJ	1966-67	Walter H. Burke, P.E. *	Harrisburg
1997-98	Pasquale A. Dougherty, P.E.*	Delaware Valley	1965-66	John P. Rutter, P.E.	Harrisburg
1996-97	David A. Greenwood, P.E.	Chesapeake	1964-65	John P. Rutter, P.E.	Harrisburg
1995-96	Thomas J. Haslett, P.E.	Franklin	1963-64	Donald R. Conrad, PE*	Clearfield
1994-95	Raymond A. Petrucci, P.E.	First State	1962-63	Russell Horn, P.E. *	Harrisburg
1993-94	Roland A. Nesslinger, P.E.	Central Ohio	1961-62	Ray Grove *	Harrisburg
1992-93	Albert W. Kozel, Jr., P.E.	Pittsburgh	1960-61	C. Edward Swartz, PE*	Harrisburg
1991-92	Samuel H. Callisto, P.E.	Altoona	1959-60	Robert L. Keller, P.E.	Harrisburg
1990-91	Stephen B. Lester, P.E.	Delaware Valley			
1989-90	Matthew J. McTish, P.E.	East Penn			

Honorary Past President Robert Sherr, P.E. *

Honorary Past President Terence D. Conner, P.E.

*Deceased



ASHE 2021 National Conference

May 25-27, 2021

ASHE Past National Conferences

YEAR	HOST	DATE	LOCATION	YEAR	HOST	DATE	LOCATION
2020	---	---	---	1988	Harrisburg	May 12-15	Harrisburg, PA
2019	Middle Tennessee	May 8 - 12	Nashville, TN	1987	East Penn Cuyahoga Valley	May 14-17	Allentown, PA
2018	Lake Erie	May 17-20	Cleveland, OH	1986	Delaware Valley	May 15-18	Fairlawn, OH
2017	New York Metro	June 14-18	New York, NY	1985	Pittsburgh	May 16-19	King of Prussia, PA
2016	Pittsburgh	May 18-22	Pittsburgh, PA	1984	* Altoona	May 17-20	Greensburg, PA
2015	Chesapeake	May 27-31	Baltimore, MD	1983	Williamsport	May 12-15	Bedford, PA
2014	Central Dacotah Central NY & Albany	June 11-15	Bismarck, ND	1982	Franklin	May 13-16	Williamsport, PA
2013	Southwest Penn	June 5-8	Lake Placid, NY	1981	Northeast Penn	May 14-17	W. Middlesex, PA
2012	Southeast Region	June 7-10	Champion, PA	1980	Harrisburg	May 15-18	White Haven, PA
2011	Region 1	June 22-26	Orlando, FL	1979	Southwest Penn	May 17-22	Hershey, PA
2010	Region 8	June 9-13	Cincinnati, OH	1978	East Penn	May 18-21	Morgantown, WV
2009	** Region 4	June 3-7	Atlanta, GA	1977	Altoona	May 19-22	Pocono Manor, PA
2008	Region 6	June 11-15	Hershey, PA	1976	Delaware Valley	May 13-16	Bedford, PA
2007	Region 7	May 20-24	Atlantic City, NJ	1975	Pittsburgh	May 15-18	Philadelphia, PA
2006	Pittsburgh	June 1-4	Williamsburg, VA	1974	Williamsport	May 23-26	Champion, PA
2005	Region 9	June 2-5	Pittsburgh, PA	1973	Franklin	May 17-20	Williamsport, PA
2004	Region 1	June 16-20 May 29-June 1	Jacksonville, FL	1972	Northeast Penn	May 18-20	Titusville, PA
2003	Franklin	June 5-9	Akron, OH	1971	Harrisburg	May 20-23	Tamiment, PA
2002	Southwest Penn	May 7-10	Erie, PA	1970	Pittsburgh	May 8-10	Hershey, PA
2001	Central Dacotah	June 28-July 1	Champion, PA	1969	Delaware Valley	May 24-25	Champion, PA
2000	Carolina Triangle	May 16-30	Bismarck, ND	1968	East Penn	25-May	Philadelphia, PA
1999	Harrisburg	May 14-17	Asheville, NC	1967	Franklin	13-May	Pocono Manor, PA
1998	Delaware Valley	May 15-17	Lancaster, PA	1966	National ASHE	21-May	Erie, PA
1997	Central Florida	May 15-17	Valley Forge, PA	1965	National ASHE	15-May	Harrisburg, PA
1996	Pittsburgh	June 26-29	Orlando, FL	1964	National ASHE Executive Meeting	23-May	State College, PA
1995	Southern NJ	May 18-21	Pittsburgh, PA	1963	Annual Meeting	25-May	Bedford, PA
1994	Chesapeake	April 29-May 2	Atlantic City, NJ	1962	Annual Meeting	29-Aug	Harrisburg, PA
1993	Central Ohio	May 14-17	Baltimore, MD	1961	Annual Meeting	8-May	Harrisburg, PA
1992	North East Penn	May 16-19	Columbus, OH	1960	Annual Meeting	16-May	Harrisburg, PA
1991	Altoona	June 6-7	White Haven, PA	1959	Charter Meeting Formation Meeting	9-Feb	Harrisburg, PA Mechanicsburg, PA
1990	Southwest Penn	May 18-21	Altoona, PA	1958	Meeting	17-Jun	PA
1989			Uniontown, PA	1957		29-Apr	Harrisburg, PA



ASHE 2021 National Conference

May 25-27, 2021

Section Charter Dates and Locations

Charter for National American Society of Highway Engineers was received May 12, 1958 with 104 Signatures

SECTION	DATE	CHARTER MEMBERS	LOCATION	REGION	SECTION	DATE	CHARTER MEMBERS	LOCATION	REGION
Harrisburg	May 8, 1961	165	Harrisburg, PA	Northeast	Central Florida	Jan 27, 1993	120	Orlando, FL	Southeast
Clearfield	June 15, 1961	Not on File	Clearfield, PA	Northeast	Central Dacotah	Oct 18, 1994	61	Bismarck, ND	North Central
Franklin	Sept 1, 1962	41	Franklin, PA	Northeast	Tampa Bay	July 12, 1995	113	Tampa Bay, FL	Southeast
Altoona	Oct 4, 1962	5	Altoona, PA	Northeast	Carolina Piedmont	Jan 11, 1996	145	Charlotte, NC	Mid-Atlantic
Southwest Penn	Jan 25, 1963	Not on File	Uniontown, PA	Northeast	Northeast Florida	Oct 15, 1996	51	Jacksonville, FL	Southeast
Williamsport	Oct 21, 1965	19	Williamsport, PA	Northeast	Georgia	Feb 5, 1998	80	Atlanta, GA	Southeast
East Penn	Oct 12, 1965	44	Allentown, PA	Northeast	South FL (Gold Coast)	July 29, 1998	36	Miami & Ft. Lauderdale, FL	Southeast
Pittsburgh	Oct 19, 1966	84	Pittsburgh, PA	Northeast	Greater Hampton Roads	Apr 25, 2000	108	Chesapeake, VA	Mid-Atlantic
Delaware Valley	Jan 25, 1967	69	Philadelphia, PA	Northeast	New York Metro	Sep 28, 2004	80	New York, NY	Northeast
North East Penn	Apr 12, 1967	94	Dunmore, PA	Northeast	Middle Tennessee	Aug 9, 2005	96	Nashville, TN	Southeast
Cuyahoga Valley	Mar 28, 1978	46	Akron, OH	Great Lakes	Derby City	Oct 4, 2006	61	Louisville, KY	Great Lakes
North Central WV	Feb 6, 1981	86	Clarksburg, WV	Mid-Atlantic	Central New York	Apr 5, 2007	71	Syracuse, NY	Northeast
Central Ohio	Apr 24, 1984	54	Columbus, OH	Great Lakes	Blue Ridge	Nov 7, 2007	65	Roanoke, VA	Mid-Atlantic
Lake Erie	May 8, 1985	62	Cleveland, OH	Great Lakes	Long Island	Oct 3, 2008	52	Melville, NY	Northeast
Southern NJ	Feb 19, 1986	109	Mt. Laurel, NJ	Northeast	Phoenix Sonoran	July 23, 2009	42	Phoenix, AZ	Rocky Mountain
First State	May 6, 1987	44	New Castle, DE	Northeast	Albany	Oct 8, 2010	77	Albany, NY	Northeast
Mid- Allegheny	Oct 1, 1987	35	Indiana, PA	Northeast	Dallas-Fort Worth	June 9, 2015	51	Fort Worth, TX	South Central
Chesapeake	Apr 21, 1988	81	Baltimore, MD	Mid-Atlantic	Bluegrass	June 1, 2017	47	Lexington, KY	Great Lakes
Triko Valley	June 9, 1989	50	Cincinnati, OH	Great Lakes	Houston	Feb 13, 2018	47	Houston, TX	South Central
Potomac	Oct 25, 1989	42	Washington, D.C.	Mid-Atlantic					
Old Dominion	Oct 23, 1990	50	Richmond, VA	Mid-Atlantic					
North Central New Jersey	Dec 5, 1990	50	Scotch Plains, NJ	Northeast					
Northwest Ohio	May 23, 1991	29	Toledo, OH	Great Lakes					
Carolina Triangle	Jan 23, 1992	186	Raleigh, NC	Mid-Atlantic					

Conference Sponsors and Advertisers



2021 National Conference Sponsors



Keynote Sponsor



Sustaining Sponsors



Conference Sponsors

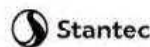

Table Sponsors



*Inwood Iron Bridge
Truss Rehabilitation and Replacement*

Lebanon County, PA



**PROUD SPONSOR OF THE
2021 ASHE NATIONAL CONFERENCE**

Engineering | Environmental | Planning & Communications
MS4 | CM/CI | Design-Build | Program Management

mccormicktaylor.com



Question the ordinary
Imagine the extraordinary
Create the enduring

Award-Winning Route 72 Manahawkin Bay Bridges Project, Ocean County, NJ

***WSP is proud to be a Platinum Sponsor at the
ASHE 2021 National Conference***

*Clients partner with WSP to mobilize communities
from coast to coast.*

Find out what we can do for you.

wsp

wsp.com/usa

Join our team! 



**THE ASHE NORTHEAST REGION
SENDS BEST WISHES FOR A GREAT 2021
NATIONAL CONFERENCE**

**Many Thanks to Our Three NE Region
Sections for making this happen!!!**

ASHE 2021
A Gateway to Transportation Adventures



Albany · Altoona · Central NY · Clearfield · Delaware Valley
East Penn · 1st State · Franklin · Harrisburg · Long Island · New York Metro · Mid-Allegheny · North
Central NJ · North East Penn · Pittsburgh · Southern NJ · Southwest Penn · Williamsport



ASHE
Middle Tennessee

**The Middle Tennessee Section THANKS the
Delaware Valley, East Penn, and North East Penn
sections for coordinating the
2021 ASHE National Conference.**



The Old Dominion Section Wishes Good LUCK and Thanks to

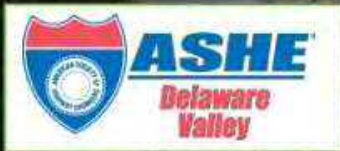

for Hosting the 2021 ASHE
Virtual National Conference



BEST WISHES TO THE
DELAWARE VALLEY, EAST PENN, &
NORTH EAST PENN SECTIONS

FOR A SUCCESSFUL
VIRTUAL 2021 ASHE NATIONAL CONFERENCE





**ASHE GEORGIA IS PROUD TO SUPPORT
THE 2021 NATIONAL CONFERENCE
AND WE LOOK FORWARD TO SEEING YOU IN 2023 WHEN
WE HOST THE NATIONAL CONFERENCE IN ATLANTA!**

**We would also like to thank our own
Tim Matthews for his continued service as our
ASHE National President for another year!**



ASHE[®]
Georgia



ASHE[®]

**Mid-Atlantic
Region**

Our Sections

Chesapeake

Potomac

North Central West Virginia

Old Dominion

Blue Ridge

Greater Hampton Roads

Carolina Triangle

Carolina Piedmont

***South Carolina coming in 2021**



The Mid-Atlantic Region Extends Best Wishes and Gratitude to



**for Hosting the 2021 ASHE
Virtual National Conference
We will see you in the Poconos Next Time !**

ASHE PITTSBURGH PROUDLY SUPPORTS THE 2021 ASHE NATIONAL CONFERENCE



*COMMITTED TO SAFE, EFFICIENT AND
SUSTAINABLE TRANSPORTATION SYSTEMS!*

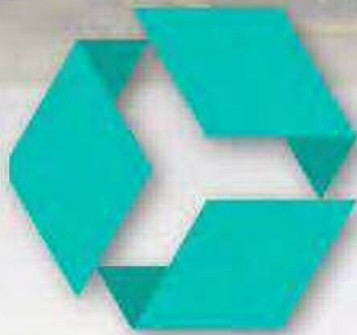

inframap

Since 1987, Inframap has been providing **professional** subsurface utility engineering and utility infrastructure mapping services. Our **expertise** and focus allow us to deliver **quality** data and a superior experience to our clients. We offer big firm capabilities with a small firm feel.

Let us put our experience to work for you.



KEN KERR, PE
EXECUTIVE VICE PRESIDENT
ASHE MEMBER 13 YEARS



DENNIS CORRELL
PROJECT MANAGER
ASHE NE PENN BOARD MEMBER

Inframap.net 800.863.3748

New Jersey Pennsylvania Maryland Virginia Georgia Florida



ASHE[®]

Chesapeake

chesapeake.ashe.pro



**Proud supporters of the ASHE
2021 National Conference!**

**Thank you to the Chesapeake Section officers, committees, members,
student chapters and sponsors for a another successful year!**

2020 – 2021 Officers

President	Andy Lynch, P.E.
Vice President	Carrie Nicholson, P.E.
Secretary	Amanda Izzo, P.E.
Treasurer	Deni Deliallisi, P.E.
Past President	Gregg Iskra, P.E.
Directors	Greg Barnes Adam Gardner, CCM Elizabeth Harasty, P.E. Lauren Havener, P.E. Reid Perry, P.E. Kathy Walsh, P.E.



PROUD SPONSOR OF THE ASHE 2021 NATIONAL CONFERENCE



Our Services Include:

- TRAFFIC ENGINEERING REPRESENTATION FOR MUNICIPALITIES
- INTERSECTION IMPROVEMENTS
- ROADWAY WIDENING
- MAINTENANCE AND PROTECTION OF TRAFFIC
- SIGNING AND PAVEMENT MARKING
- TRAFFIC CALMING
- ROUNDABOUT DESIGN
- ADA DESIGN
- INTERCHANGE DESIGN
- TRAFFIC SIGNAL DESIGN
- LEFT WAY OCCUPANCY PERMITS (LWOP)
- TRAFFIC SIGNALS PERMITS (TSP)
- TRAFFIC IMPACT STUDIES
- SAFETY STUDIES
- BICYCLE AND PEDESTRIAN STUDIES
- SPEED MANAGEMENT
- UTILITY RELOCATION
- UAV SERVICES



Bucks County Office:
949 Easton Road
Warrington, PA 18976
215-343-6700

Montgomery County Office:
630 Freedom Business Center, Third Floor
King of Prussia, PA 19406
610-489-5100

Chester County Office:
101 Lindenwood Drive, Suite 225
Malvern, PA 19355
484-875-3075

New Jersey Office:
105 Raider Boulevard, Suite 206
Hillsborough, NJ 08844
908-874-7500

www.carrollengineering.com | info@carrollengineering.com | [f](#) [in](#) [v](#)



The Community That Builds Communities

- Highway and Street Design
- Bridge Design
- Traffic Engineering
- Stormwater Management
- Construction Services
- Geospatial Services

erdmananthony.com



Congratulations

Chad Martin, PE, PTOE
Erdman Anthony Project Manager
Central PA Engineers Week Council
2021 Young Engineer of the Year



The founding section of the American Society of Highway Engineers, established in 1958, is proud to support the ASHE 2021 National Conference



ASHE Harrisburg Section
P.O. Box 322
Camp Hill, PA 17001-0322
www.harrisburg.ashe.pro



TURNING IDEAS INTO REALITY

Highways and bridges are the country's arteries. They help the nation move—whether it be commuting to work or school, transporting goods and services or simply being able to go from point A to point B. AECOM is at the forefront, planning, designing and constructing essential and needed surface transportation projects.

With more than 100 years of highway and bridge project experience, we deliver sustainable, reliable and visionary infrastructure.

aecom.com

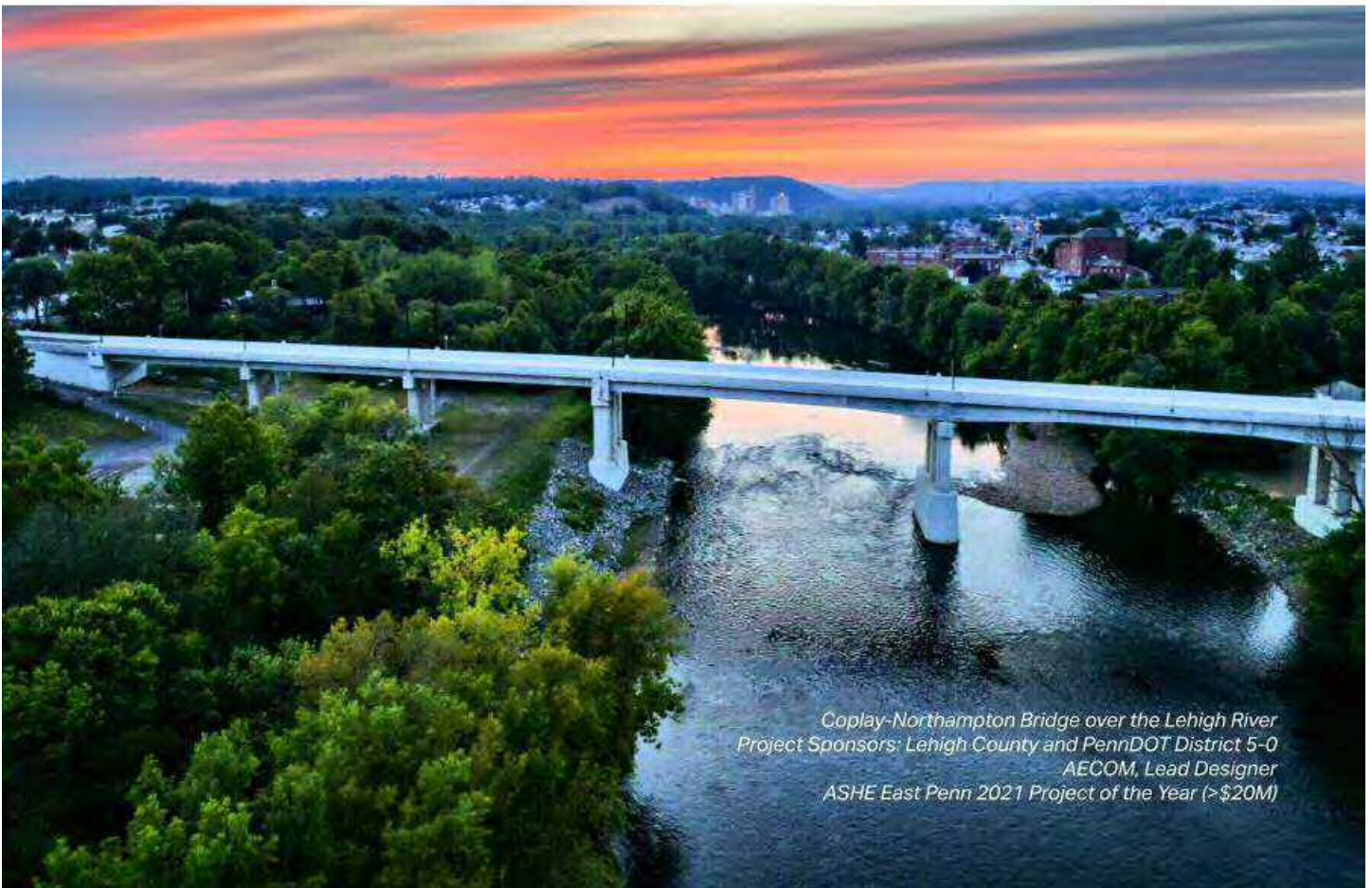

*Coplay-Northampton Bridge over the Lehigh River
Project Sponsors: Lehigh County and PennDOT District 5-0
AECOM, Lead Designer
ASHE East Penn 2021 Project of the Year (>\$20M)*



ASHE[®]

**Cuyahoga
Valley**

would like to extend Best Wishes to



ASHE
Delaware
Valley



ASHE
East Penn



ASHE
North East Penn

for hosting a Successful

ASHE 2021

Virtual National Conference!



www.cuyahogavalley.ashe.pro



Value Focused.
Community Minded.
Quality Driven.

www.benesch.com

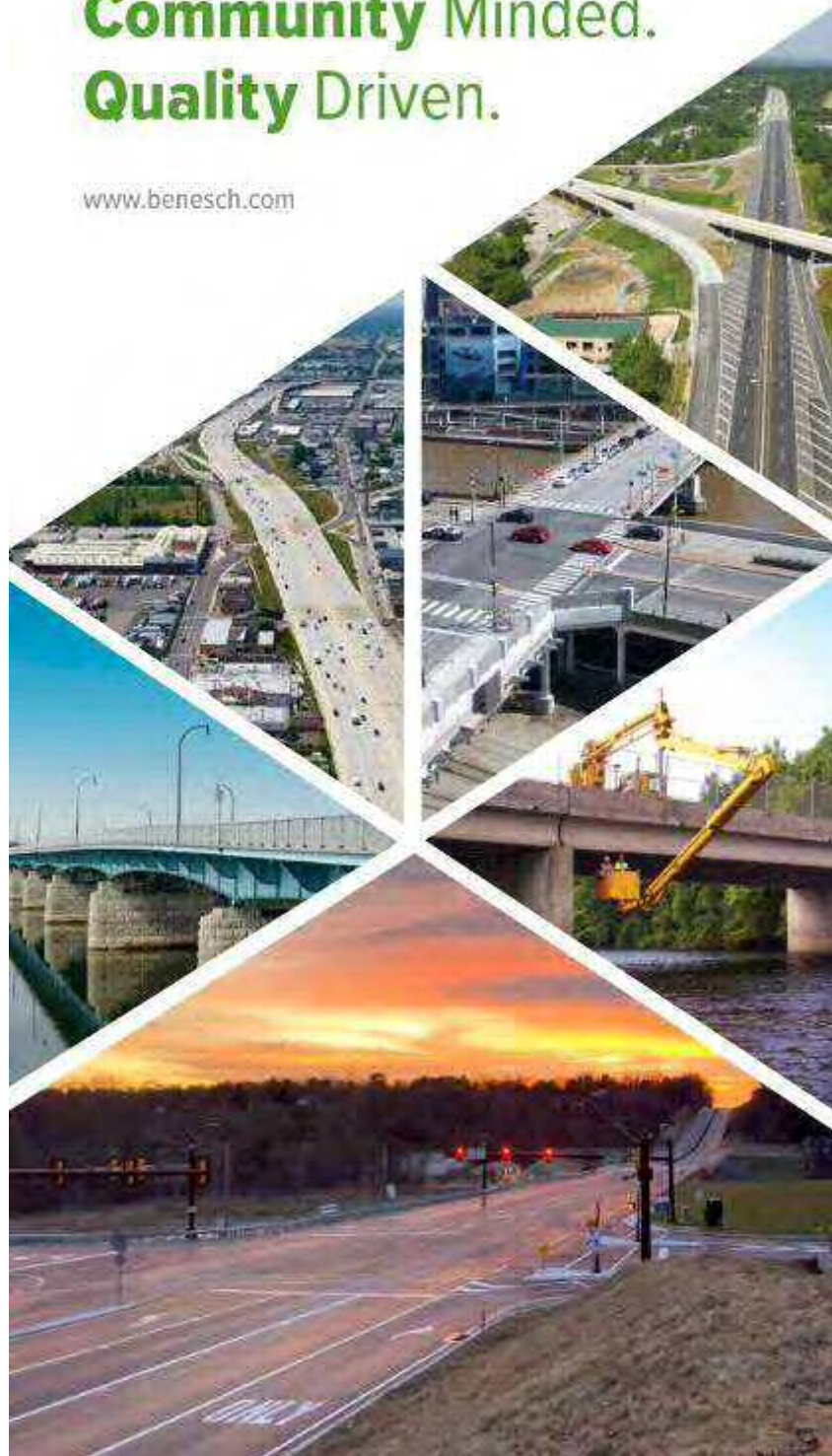



ASHE Central Dacotah is
proud to sponsor the

2021
National
Conference

*The **Albany Section** wishes great success to ASHE's first (and hopefully only) Virtual National Conference hosted by the **Eastern Pennsylvania Sections***

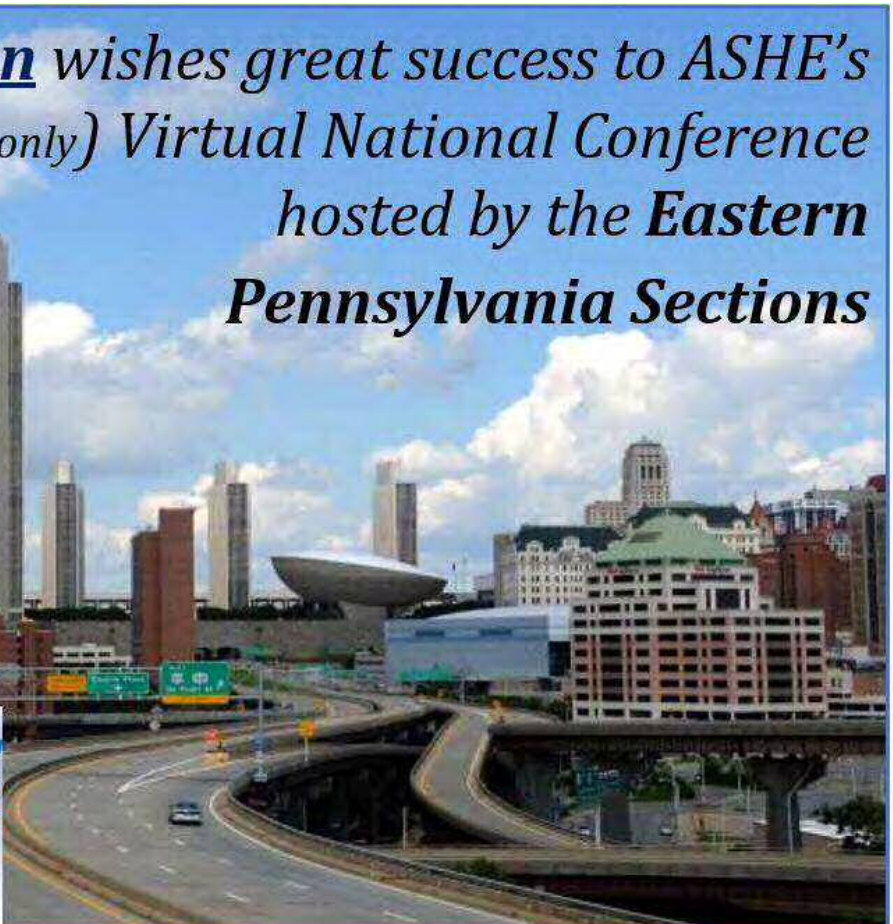

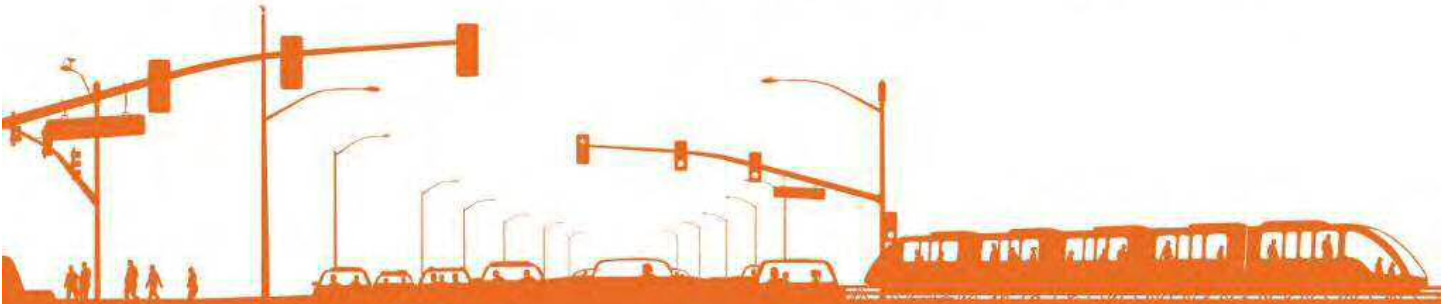

Roads and rail — revisited.

Today's transportation systems must do more than connect neighborhoods and communities: they must demonstrate economic and social value while balancing the needs of the natural environment. Our industry-leading specialists apply innovative technology and extensive US and global expertise to deliver the infrastructure of the future.

Arcadis.
Improving quality of life.





Pennsylvania 811

A Privately funded non-profit Pennsylvania Corporation



Coordinate PA is a web application developed by Pennsylvania One Call System to support public works, utility project planning and utility coordination within the Commonwealth of Pennsylvania. Users utilize a spatial, map-based system to view underground utility and public works projects, identifying opportunities for coordination and collaboration when projects overlap in space and time.

Coordinate PA Benefits:

- Define projects using a web application (No special software required!) Store project data and records in a secure repository
- Gather and disseminate information to a broader range of stakeholders beyond project planners and public works officials
- Coordinate and collaborate on projects outside your scope of responsibility, saving money and improving service for all parties
- Request meetings and upload documents associated with a complex project

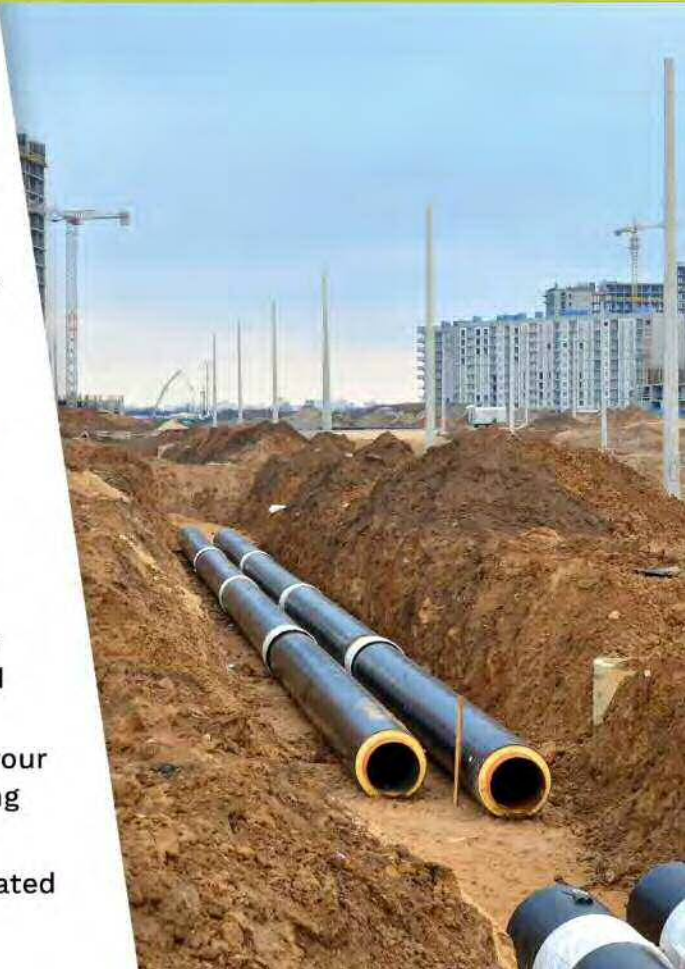

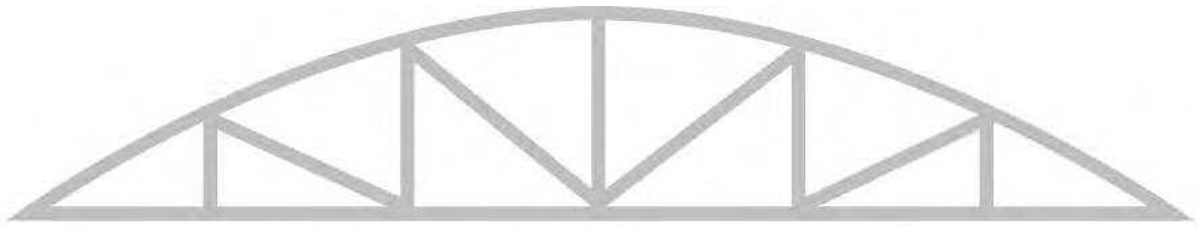

P. JOSEPH LEHMAN, INC.

CONSULTING ENGINEERS



Thank you to our
Annual Sponsors!



*Congratulations to Chuck Sukanek, P.E. for his
achievement as an ASHE Life Member!*

www.centralfl.ashe.pro

